



7 Tambor Court Lalor, VIC



3



1



3

## A Wonderful Step Into The Property Market

A rare gem in a high-demand pocket of Lalor, this brick-veneer beauty on a decent corner allotment is a tightly held treasure amidst beautiful established gardens. A freshly painted interior introduces a warm atmosphere to a flexible interior flanked by zoned sleeping quarters and separate living spaces. Glass feature windows and rich polished hardwood floorboards create an impressive depth of character throughout. The layout offers three spacious bedrooms serviced by an immaculate family bathroom and laundry as well as a cinema room/rumpus, adjoined by an open plan kitchen dining and living area. The kitchen comes equipped with modern appliances, plentiful storage, and lots of counter space for meal preparation. The low maintenance yard offers provisions for vegetable and herb gardens along with a pergola and two storage sheds. There is also the added appeal of an extra-large garage with added car spaces, as well as side gate access (via Pinetree Cres) to secure a boat, caravan or car. Added features also include, ducted heating and evaporative cooling, split system heating/cooling, a heating unit in the lounge, external window shutters and ample under house storage. This beautiful home is one not to be missed, as it presents buyers with several opportunities, you could comfortably move straight in or renovate to your own personal style. Walking distance to local primary schools, public transport, parklands, and lots more!

**Price:** \$670,000 - \$730,000  
**Inspect:** Saturday, 9th May 2026 2:45 - 3:15  
Wednesday, 13th May 2026 5:00 - 5:30  
**Auction:** 2026-05-30  
**Details:** 13:00:00

---



**Jim Kalakias**

0402 177 336

[jim.k@lovere.com.au](mailto:jim.k@lovere.com.au)

# 7 Tambor Court, Lalor

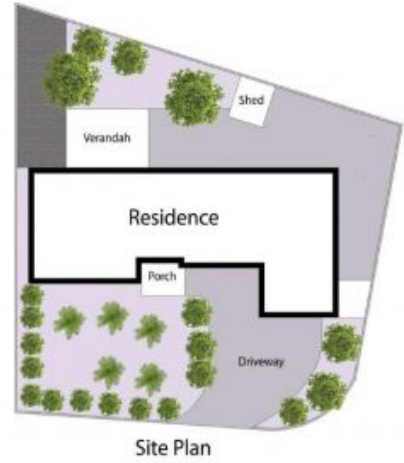

THE ABOVE PLAN IS AN ARTIST'S IMPRESSION ONLY. IT INCLUDES ELEMENTS THAT ARE FOR DISPLAY PURPOSES ONLY AND MAY NOT BE TO SCALE. LANDSCAPING SHOWN IS INDICATIVE ONLY. DIMENSIONS ARE APPROXIMATE.

