



1 Essex Court Epping, VIC



4



2



2

## Welcome Home!

A sun-kissed sanctuary brimming with plenty of space and modern style, this outstanding family home offers a lifestyle of peaceful relaxation and indoor-outdoor enjoyment. The generous interior reveals multiple living zones alongside a stylish kitchen and dining area that's equipped with modern appliances including a Smeg oven, dishwasher and ample storage. Sleeping arrangements include four spacious bedrooms serviced by two neat bathrooms and laundry. There is also a generous yard for outdoor activities including a native garden, brick BBQ, an entertaining deck and double garage. Added features also include plentiful storage options, polished timber floors, split system heating/cooling units, evaporative cooling, a dedicated study, outdoor WC, and storage shed. Surrounded by lively lifestyle amenity, near to local walking tracks, public transport, local schools and Epping Plaza.

\* Four bedrooms are serviced by two bathrooms and large laundry

**Price:** \$700,000 - \$750,000  
**Inspect:** Saturday, 9th May 2026 1:45 - 2:15  
 Thursday, 14th May 2026 5:00 - 5:30  
**Auction:** 2026-05-30  
**Details:** 11:00:00



**Jim Kalakias**

0402 177 336  
 jim.k@lovere.com.au



**Bijan Rahimi**

0451 515 301  
 bijan.r@lovere.com.au

# 1 Essex Court, Epping

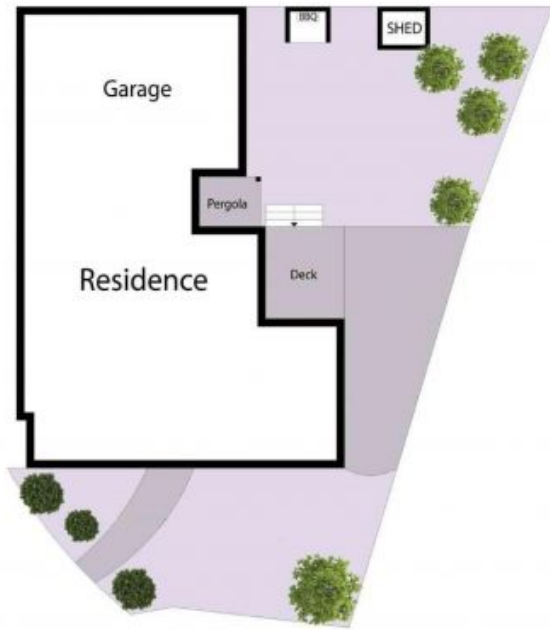

Site Plan

THE ABOVE PLAN IS AN ARTIST'S IMPRESSION ONLY. IT INCLUDES ELEMENTS THAT ARE FOR DISPLAY PURPOSES ONLY AND MAY NOT BE TO SCALE. LANDSCAPING SHOWN IS INDICATIVE ONLY. DIMENSIONS ARE APPROXIMATE.

