



111 High Street Thomastown, VIC

## Prime Medical Consulting Rooms for Lease

Positioned within a well-established and high-exposure medical centre, this excellent leasing opportunity offers two spacious consulting rooms, each approximately 3.3m x 4.7m. Both rooms are fully equipped with split system heating and cooling, as well as their own fully plumbed sinks, making them ideal for a range of medical or allied health professionals.

The premises feature a welcoming reception area with additional shared seating for patients, creating a professional and comfortable environment. Tenants will also benefit from access to a shared storage room for stock and filing, modern shared kitchen amenities, and an additional adjoining space suitable for a printer, filing cabinets, or foyer use.

Further enhancing the convenience is access to a shared 13-car parking area, ensuring ease for both staff and clients.

? Two consulting rooms (approx. 3.3m x 4.7m each)

LOVE & CO

**Bijan Rahimi**

0451 515 301

loverealestate@mail.inspectreale



111 High Street - Floor Plan

All measurements are in metres. This plan is not to scale and provided as marketing material. All measurements are approximate and for illustrative purposes only. We make no guarantee of the accuracy of the plan, and you should independently determine the suitability of the property for your requirements.

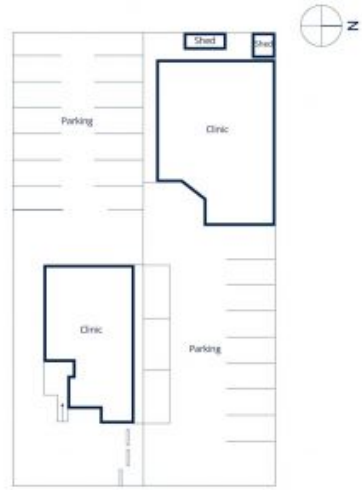

111 High Street - Site Plan