



6 Heroic Court Mill Park, VIC



4



2



2

### Original Charm, Solid Build & Endless Family Appeal

Set in a peaceful court location, this much-loved and exceptionally well-maintained home offers the perfect opportunity for families, first-home buyers or savvy investors seeking space, comfort and convenience in the heart of Mill Park.

Proudly presented in very good original condition, this solid single-storey residence features four generous bedrooms, providing ample accommodation for growing families. A traditional L-shaped lounge and dining area at the front of the home creates a warm and inviting space for formal entertaining, while the central kitchen overlooks a light-filled open plan meals and family zone-ideal for everyday living.

Step outside to discover a spacious rear yard complete with an entertaining area, perfect for hosting family gatherings or simply enjoying the outdoors. A double garage adds further practicality and secure parking.

**Price:** \$875,000 - \$895,000  
**Inspect:** Saturday, 9th May 2026 11:45 - 12:15



**George Bottas**  
 0487798888  
 george.b@lovere.com.au



**John Gioftsidis**  
 0410 522 195  
 john.g@lovere.com.au

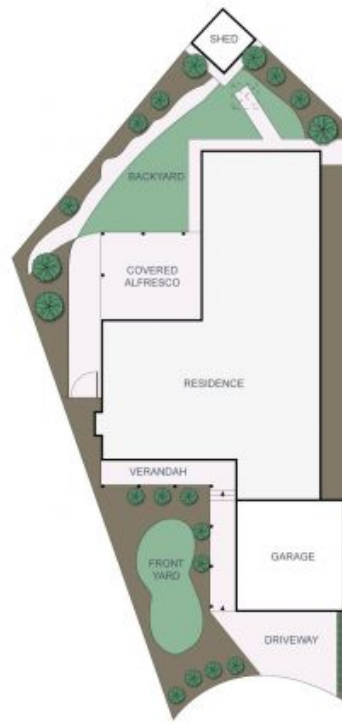

Every precaution has been taken to verify the accuracy of the above details. However, prospective purchasers are advised to make their own enquiries.