



2 Juniper Crescent Thomastown, VIC



A Well Appointed Home Offering Space, Comfort and Potential

Set in a quiet and well-established pocket of Thomastown, this welcoming residence presents a functional layout with generous indoor and outdoor spaces, ideal for families, first home buyers or investors alike.

Comprising three well-proportioned bedrooms, the home is complemented by a spacious living area and a practical kitchen and meals zone designed for everyday comfort. Natural light fills the interior, creating a warm and inviting atmosphere throughout.

Positioned on a substantial allotment, the property offers excellent outdoor space with room to enjoy, entertain or further enhance if desired. A central bathroom, one toilet, separate laundry and ample storage add to the home's everyday practicality, while secure off-street parking accommodates multiple vehicles with ease.

Price:

Contact Agent



Ryan Di Natale

0418 330 587
ryan.d@lovere.com.au



Jude Kattan

0450 848 255
jude.k@lovere.com.au

2 Juniper Crescent, Thomastown

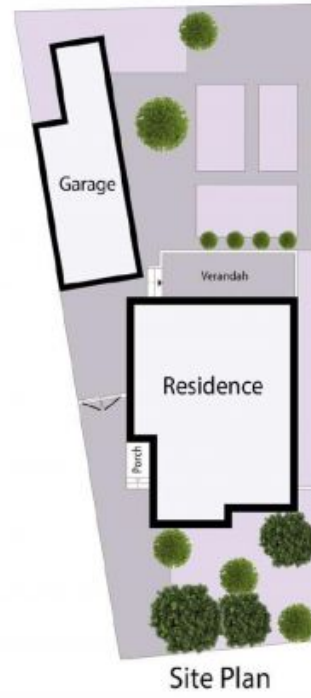

THE ABOVE PLAN IS AN ARTIST'S IMPRESSION ONLY. IT INCLUDES ELEMENTS THAT ARE FOR DISPLAY PURPOSES ONLY AND MAY NOT BE TO SCALE. LANDSCAPING SHOWN IS INDICATIVE ONLY. DIMENSIONS ARE APPROXIMATE.

