



20 Eastwood Street Wollert, VIC



Serene Estate Living

Sale by Set Negotiation - Offers close Tuesday 24th February at 6:00pm Unless Sold Prior

Price: SOLD

Introducing this modern family residence that delivers an outstanding Wollert lifestyle, with easy access to schools, local shopping hubs, amenities, transportation, arterials, and parklands. The light-filled interior is beautifully presented and is enhanced by its spacious dimensions. The entrance passageway flows past a master bedroom with walk in robe and ensuite and second bedroom, before revealing a grand open plan kitchen, dining, and living zone at the rear. The immaculate kitchen displays an abundance of storage and counter-space along with stainless steel appliances. A connecting passageway gives access to an additional bedroom, family bathroom and laundry. The rear yard with a large decked pergola is great for entertaining and offers plenty of space for the kids to play and explore. Added highlights also include, heating, cooling and a double car garage.



Jim Kalakias

0402 177 336
jim.k@lovere.com.au



Ibby Zayat

0466 261 130
ibby.z@lovere.com.au

20 Eastwood Street, Wollert

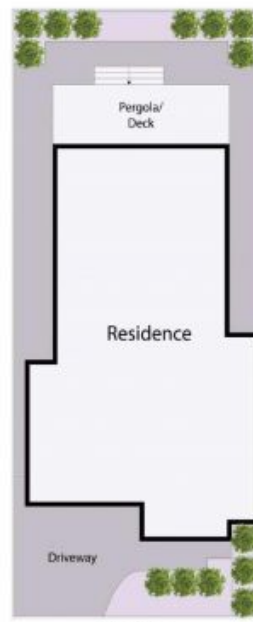

Site Plan

THE ABOVE PLAN IS AN ARTIST'S IMPRESSION ONLY. IT INCLUDES ELEMENTS THAT ARE FOR DISPLAY PURPOSES ONLY AND MAY NOT BE TO SCALE. LANDSCAPING SHOWN IS INDICATIVE ONLY. DIMENSIONS ARE APPROXIMATE.

