



25 Jocelyn Street Lalor, VIC

 3

 1

 2

1970's Splendor

Beautifully presented and immaculately cared for, this inviting family home boasts a number of opportunities for buyers looking to enter the property market. Pretty gardens create a lovely welcome to this 1970's brick veneer home. Displaying three brightly lit bedrooms nearby to a central bathroom and laundry, along with a formal dining and casual kitchen/meals and living area. The immaculate kitchen showcases fabulous storage along with stainless steel appliances. The delightful rear yard offers an undercover patio for outdoor celebrations, as well as an outdoor kitchenette and double garage. Additional features also include heating, cooling, external window shutters, polished hardwood floors and plenty of off-street parking. Positioned within close proximity to Epping Plaza, Costco, local schools, transport, parklands and amenities.

- * Multiple living areas with connecting yard.
- * Three bedrooms serviced by a neat bathroom and laundry.

Price: SOLD - \$800,000



Marc Romeo
0438 100 781
marc.r@lovere.com.au



Frank Romeo
0438 010 974
frank.r@lovere.com.au

25 Jocelyn Street, Lalor

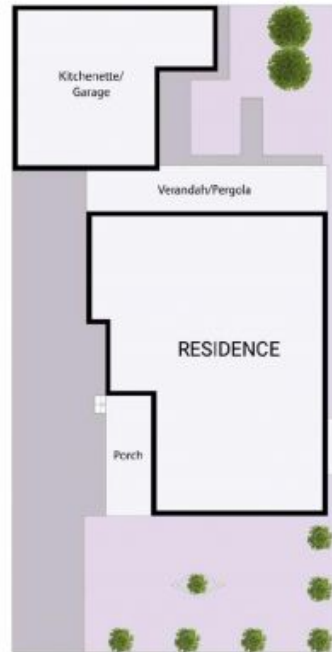

Site Plan

THE ABOVE PLAN IS AN ARTIST'S IMPRESSION ONLY. IT INCLUDES ELEMENTS THAT ARE FOR DISPLAY PURPOSES ONLY AND MAY NOT BE TO SCALE. LANDSCAPING SHOWN IS INDICATIVE ONLY. DIMENSIONS ARE APPROXIMATE.

