



8/1A Hamilton Street Alphington, VIC



The Best Of Inner City Living

This remarkable town residence is perfectly positioned on the edge of the Yarra and set to the rear of a boutique complex of ten in a quiet cul-de-sac. Built to perfection and designed to optimise light and space, this contemporary home is only 6kms from the CBD and in close range to public transport, Station Street shopping strip, Northcote Plaza, the Eastern Freeway, Alphington Grammar, Fairfield Primary School and highly recommended cafes and restaurants. Offering luxury and comfort at every angle, this open plan residence offers an expansive floorplan to relax in. The first level welcomes you with a wide entrance hallway and European laundry along with two double sized bedrooms each with BIR and a central bathroom with second bedroom access. Upstairs you'll find a vast open plan kitchen/meals and living area complete with stone benchtop, stainless-steel appliances and ample storage. A sliding door opens out to a private entertainer's undercover courtyard balcony. As well as, an additional bathroom and the private master suite with walk in robes. Additional features also include Messmate hardwood timber floorboards, split system heating/cooling throughout, double garage with internal access, LED lighting and quality window furnishings.

Price: SOLD - \$950,000



Theo Angelopoulos

0414 813 160
theo.a@lovere.com.au

0414 813 160
theo.a@lovere.com.au

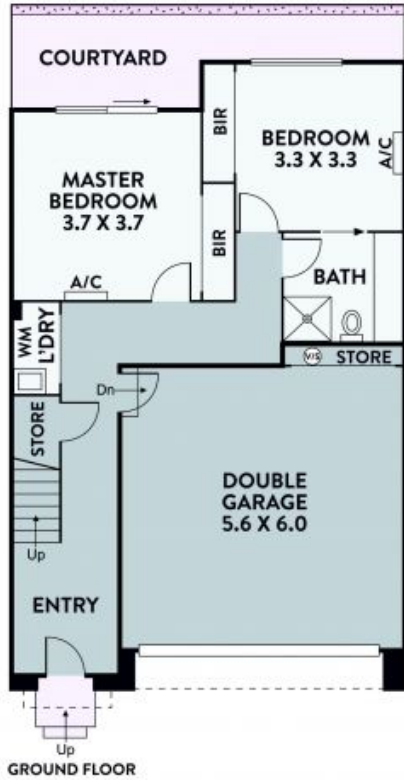

Every precaution has been taken to establish accuracy of the information in this brochure but does not constitute any representation by the vendor or agent.



LOVE & CO

LOVE & CO

8/1A Hamilton Street

Alphington, VIC