



2 Eccles Close Mill Park, VIC



Walk To Westfield

Outstanding 3 bedroom town home with Federation appeal, only a stone's throw from Westfield Shopping Centre, Train Station, YMCA, picturesque Parklands and selection of schools both primary and secondary.

Offering an ideal lifestyle for young families, downsizers, elderly and investors looking for an attractive return.

The home is ready for immediate occupation with a tasteful refurbishment recently completed.

Complete with central heating and split system cooling, homes in this price range and premium locale are hard to come by.

Put this one on your inspection list.

Price: \$670,000



Jim Vasiliou

0418 123 054
jim.v@lovere.com.au



John Gioftsdis

0410 522 195
john.g@lovere.com.au

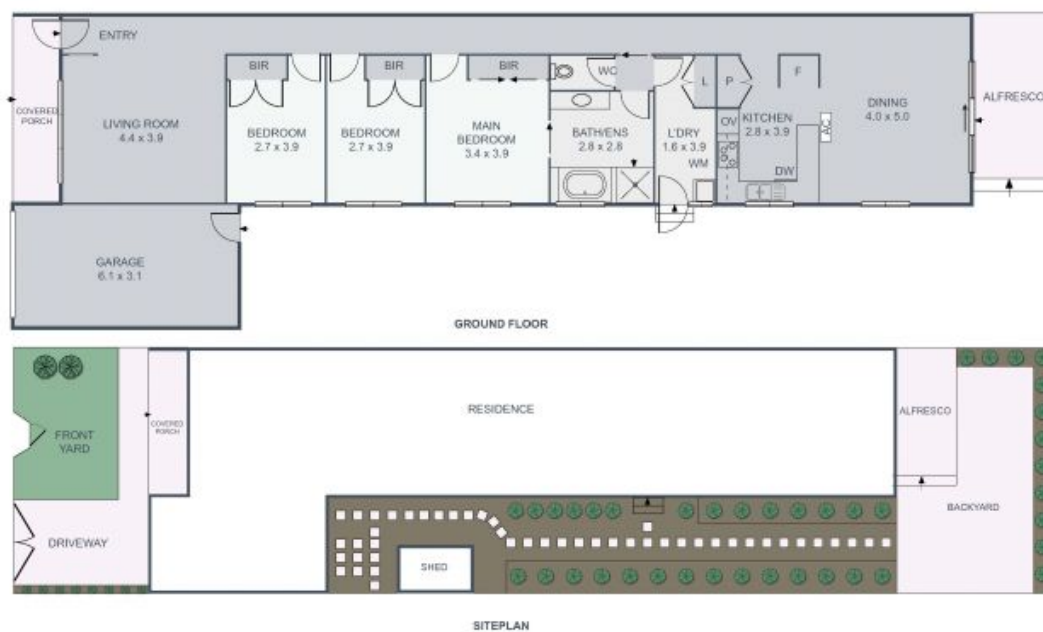

Every precaution has been taken to verify the accuracy of the above details.
However, prospective purchasers are advised to make their own enquiries.

LOVE & CO

2 Eccles Close

Mill Park, VIC