



86A Mcdonalds Road Epping, VIC



### Spacious Dimensions In A Well-Connected Locale

Big in all the right places, this surprisingly spacious home sets an impressive precedent for low-maintenance living. Positioned in a well-connected Epping locale, only a short distance to local schools, shopping, parklands and amenities. The floorplan includes two sizeable bedrooms, a family bathroom and large laundry plus well sized living zone that adjoins a spacious kitchen/meal. The immaculate kitchen comes equipped with modern appliances, ample storage and counter space. Added features also include heating/cooling, tiled floors, low maintenance courtyard gardens and a dedicated garage. This abode is a tempting prospect for the first home buyer, investor or down-sizer hesitant on sacrificing space, so be quick to inspect!

- \* Two bedrooms serviced by an immaculate bathroom and laundry.
- \* Spacious open plan kitchen, meals and living area with courtyard.

**Price:** SOLD - \$545,000



**Jim Kalakias**  
0402 177 336  
jim.k@lovere.com.au



**Jim Kalakias**  
0402 177 336  
jim.k@lovere.com.au

# 86A McDonalds Road, Epping

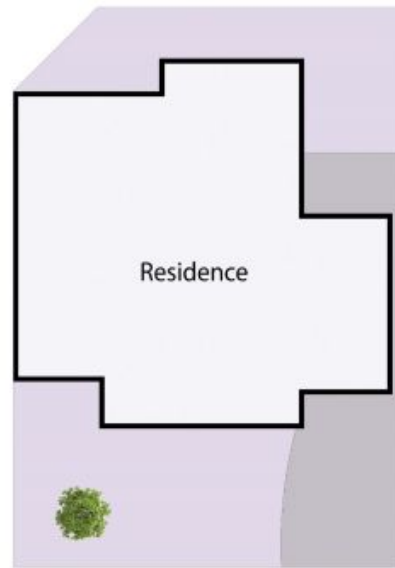
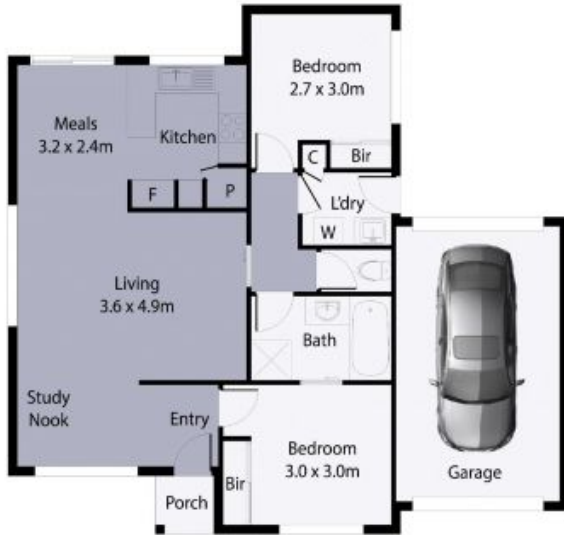

Site Plan

THE ABOVE PLAN IS AN ARTIST'S IMPRESSION ONLY. IT INCLUDES ELEMENTS THAT ARE FOR DISPLAY PURPOSES ONLY AND MAY NOT BE TO SCALE. LANDSCAPING SHOWN IS INDICATIVE ONLY. DIMENSIONS ARE APPROXIMATE.

