



23 Frewin Street Epping, VIC



Spacious Dimensions In A Well-Connected Locale

*Sale by Set Negotiation - Offers close Tuesday, 28th October at 6:00pm * Unless Sold Prior

A captivating mix of spacious style, detailed quality and low-maintenance luxury. This beautifully balanced home seamlessly flows over a vast single level layout. Nestled in a tranquil, family-friendly neighbourhood, this home has been carefully crafted into a truly functional masterpiece. The interior opens into a welcoming entrance passageway that flows past a separate living zone, before stepping into an open plan kitchen, dining and living domain at the rear, framed by doors accessing a wonderful rear yard with plenty of space for entertaining, with minimal upkeep. The stone kitchen showcases stainless steel appliances and plentiful storage. Sleeping accommodation includes four spacious bedrooms (or three with a study) serviced by two stylish bathrooms. Additional highlights also include heating, cooling, tiled flooring, carpets and a remote garage. Brilliantly positioned within close distance to parklands, schools, local shopping hubs, public transport, and much much more!

Price: SOLD - \$725,000



Jim Kalakias
0402 177 336
jim.k@lovere.com.au



Jim Kalakias
0402 177 336
jim.k@lovere.com.au

23 Frewin Street, Epping

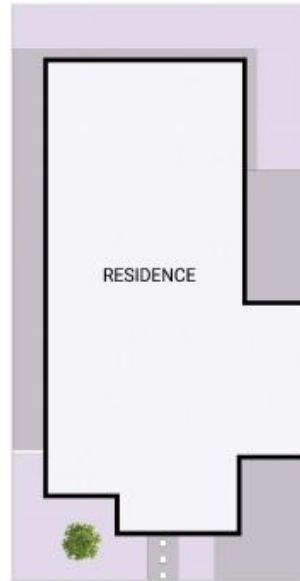
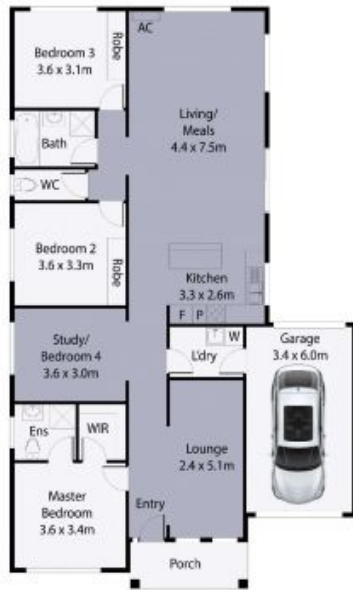

Site Plan

THE ABOVE PLAN IS AN ARTIST'S IMPRESSION ONLY. IT INCLUDES ELEMENTS THAT ARE FOR DISPLAY PURPOSES ONLY AND MAY NOT BE TO SCALE. LANDSCAPING SHOWN IS INDICATIVE ONLY. DIMENSIONS ARE APPROXIMATE.

