



118 Barry Road Thomastown, VIC



4



2



6

Expansive Family Home In A Prime Location

Set on a superb allotment of approximately 530m2, this solid four-bedroom family home presents an outstanding opportunity for buyers seeking space, comfort and convenience. Situated in a sought-after Thomastown pocket, it is close to schools, shops, public transport and local parklands, making it an ideal choice for growing families.

Step inside to discover multiple living zones, including a formal lounge, a separate dining room and a spacious open-plan living and meals area. A timber-detailed kitchen with ample storage and bench space caters to family dining with ease.

Accommodation comprises four generously sized bedrooms, including a main suite with walk-in robe and ensuite, complemented by a central bathroom and a fully appointed laundry.

Price:

Contact Agent



Ryan Di Natale

0418 330 587
ryan.d@lovere.com.au



Jude Kattan

0450 848 255
jude.k@lovere.com.au

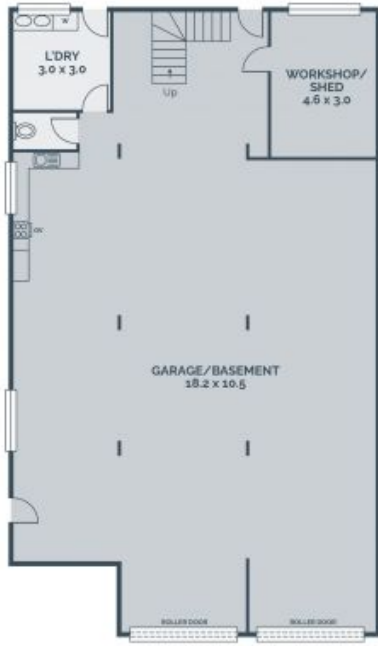

GROUND FLOOR



LEVEL 1

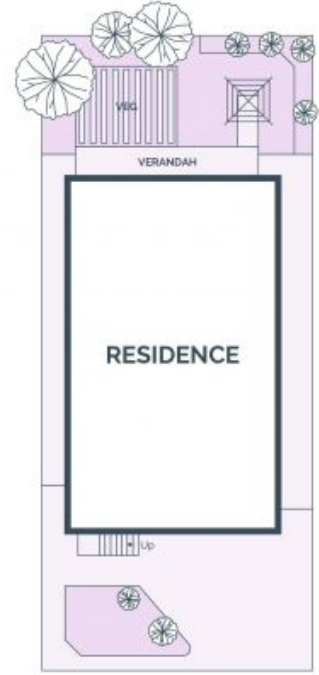

SITE PLAN

Every precaution has been taken to establish accuracy of the information in this brochure but does not constitute any representation by the vendor or agent.