



10 Tooth Court Mill Park, VIC

4 3 2

Beautifully Designed Split-Level Family Home / First Time Offered In 30 Years!

Solidly crafted and spaciouly planned, this impressive split-level residence delivers exceptional family comfort in a sought-after Mill Park position. Thoughtfully designed across multiple levels, the home offers generous space and separation for easy family living.

Comprising multiple oversized entertaining domains and fantastic garaging plus off-street parking, it has been meticulously maintained and fully secured for a seamless lifestyle. Relax in the refined comfort of the formal lounge and dining areas (a few steps down from the main entrance) or enjoy casual interactions in the family/meals area adjoining the elegant kitchen, complete with functional appliances and excellent storage.

A few steps up lead to two of the four spacious bedrooms and a central family bathroom with spa, while the remaining bedrooms are conveniently located on other levels, offering privacy and flexibility for growing families. The home also includes a basement level with internal stair access, featuring a generous living area with kitchenette and large laundry.

Price: SOLD



Jim Kalakias

0402 177 336
jim.k@lovere.com.au



Jim Kalakias

0402 177 336
jim.k@lovere.com.au

10 Tooth Court, Mill Park



Ground Floor



First Floor



Second Floor

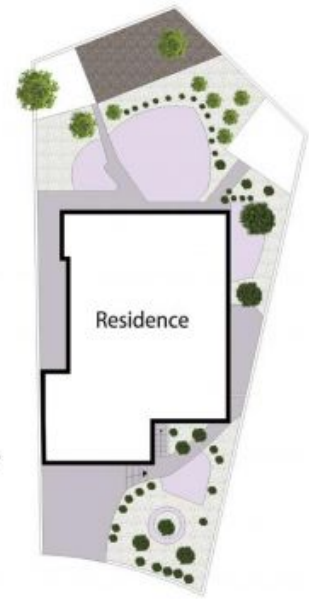

Site Plan

THE ABOVE PLAN IS AN ARTIST'S IMPRESSION ONLY. IT INCLUDES ELEMENTS THAT ARE FOR DISPLAY PURPOSES ONLY AND MAY NOT BE TO SCALE. LANDSCAPING SHOWN IS INDICATIVE ONLY. DIMENSIONS ARE APPROXIMATE.

