



2/1a Hamilton Street Alphington, VIC

2 2 1

### Contemporary Style With Spacious Dimensions

Contemporary style and designer finishes define this rare dual-level abode that's located in a well-connected pocket of Alphington. Spacious yet easily managed proportions see a welcoming entrance, that flows past a large master bedroom (courtyard access) alongside a lovely bathroom and Euro laundry. Upstairs you'll find a generous open plan kitchen, dining and living zone connected to a sunny enclosed balcony. The open stone benchtop kitchen showcases plentiful storage and quality appliances. There's also the added appeal of a second bedroom on this level and second bathroom. Added highlights also include polished timber flooring, split system heating/cooling and a remote garage. Quietly positioned at the front of a boutique development, close to public transport, parklands and Fairfield Village and local amenities.

- \* Two bedrooms serviced by two bathrooms.
- \* Open plan kitchen, meals and living.

**Price:** SOLD



**Theo Angelopoulos**

0414 813 160  
theo.a@lovere.com.au

0414 813 160  
theo.a@lovere.com.au

# 2/1A Hamilton Street, Alphington

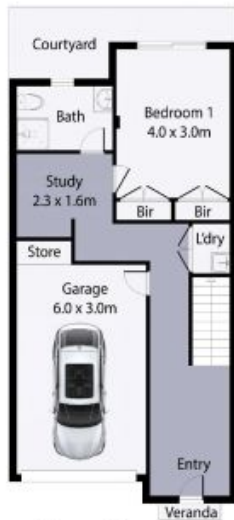

Ground Floor



First Floor



Site Plan

