



1/12 Portsmouth Place Epping, VIC

 2
  1
  2

Front Unit with Private Driveway & No Owners Corp Fees

Perfectly positioned in a quiet Epping pocket, this spacious single-level unit offers an outstanding opportunity for first home buyers, downsizers, and investors alike.

In very good original condition, the home boasts two large bedrooms, a generous living room and a well-sized kitchen/meals area that flows seamlessly to a private, grassy rear yard ? ideal for entertaining, relaxing or enjoying with family.

Adding further appeal, this front unit enjoys the benefit of its own driveway, a single garage, and the rare advantage of no owners corporation fees. With only one other unit on the block, peace and privacy are assured.

Price: \$589,000



John Gioftsidis

0410 522 195
john.g@lovere.com.au



George Bottas

0487798888
george.b@lovere.com.au

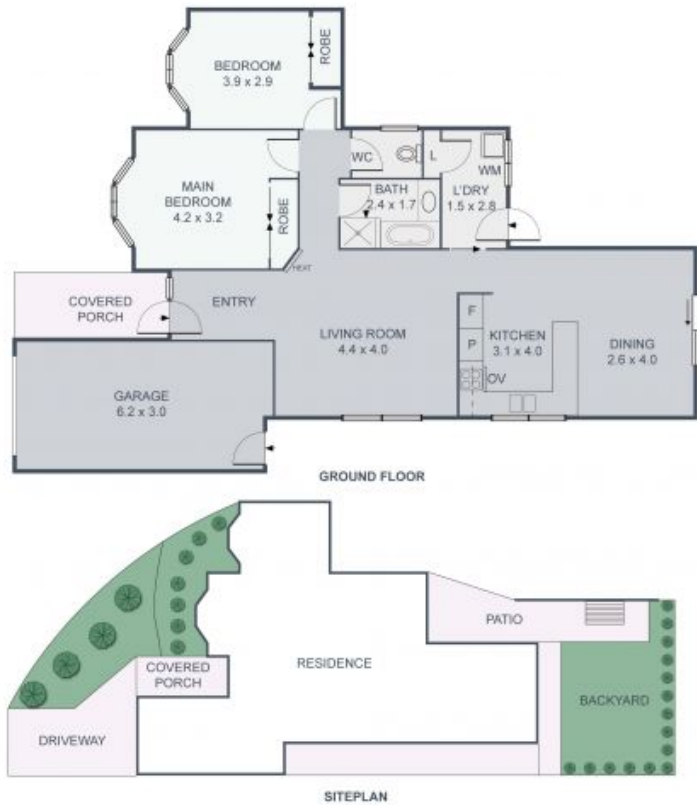

Every precaution has been taken to verify the accuracy of the above details. However, prospective purchasers are advised to make their own enquiries.