



5/8 Brand Drive Thomastown, VIC

Secure 440m2 (approx.) Industrial Warehouse / Panel Shop

Love & Co is pleased to present 5/8 Brand Drive Thomastown to you.

A Prime Office/Warehouse /Workshop, centrally located in one of Thomastown's premier industrial precincts, nearby to Dalton Road, Settlement Road and the Metropolitan Ring Road

Features: 15Kw Solar system in place.

Location: Situated within a vibrant industrial precinct, surrounded by a diverse mix of retail and service-oriented businesses.

Property Upside: The property would be suitable to a range of business, and is currently set up as a panel shop

Price: UNDER OFFER



Branko Agatanovic

0448 035 565

branko.a@lovere.com.au

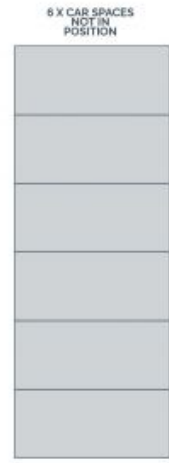
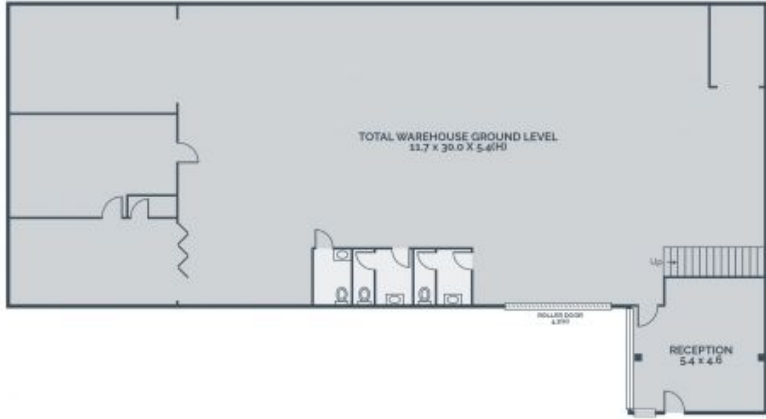

TOTAL SQM: 440 M²
GROUND: 375.8 M²
MEZZANINE: 64.2 M²

Every precaution has been taken to establish accuracy of the information in this brochure but does not constitute any representation by the vendor or agent.

LOVE & CO

LOVE & CO

5/8 Brand Drive

Thomastown, VIC