



7 Sheffield Court Thomastown, VIC



4



1



2

### Spacious Family Living in a Quiet Court Location

Welcome to 7 Sheffield Court, a beautifully presented family home offering comfort, space, and practicality in one of Thomastown's most peaceful and convenient pockets.

This Brick Veneer brick residence features two toilets, 4 generous bedrooms, including a master with built-in robes, while the second and third bedrooms also boast built-in robes ? ideal for growing families or those needing extra space.

Step inside to discover a large light-filled living area perfect for family gatherings, flowing seamlessly into a well-appointed kitchen and meals area, designed with both function and comfort in mind.

The home is equipped for year-round comfort with ducted heating and a split system for cooling, ensuring you're covered no matter the season. A sunroom at the rear of the home provides a versatile space ? perfect as a second living zone, home office, or kids' playroom.

**Price:**

Contact Agent



**Jude Kattan**

0450 848 255  
jude.k@lovere.com.au



**Ryan Di Natale**

0418 330 587  
ryan.d@lovere.com.au

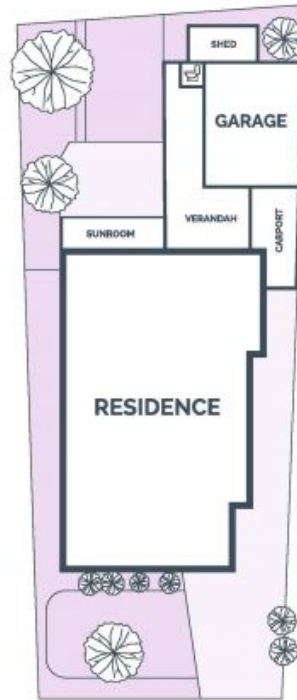

Every precaution has been taken to establish accuracy of the information in this brochure but does not constitute any representation by the vendor or agent.