



14 Sieben Close Mill Park, VIC

 4
  2
  4

Spacious, Secure & Superbly Located

Tucked away in a quiet court location, this well-kept home offers generous space, smart functionality, and impressive vehicle accommodation ? making it ideal for growing families or savvy investors.

Step inside to find four comfortable bedrooms, a large L-shaped lounge and dining area, and a central kitchen with an adjoining meals and family space. The layout is both practical and versatile, offering room to relax, entertain, or work from home.

Out back, a spacious undercover area provides the perfect setting for year-round entertaining, with plenty of room for gatherings, kids, or weekend BBQs.

Car lovers, tradies, and those needing storage will love the long gated driveway, double carport, double garage, and rear storage room ? all neatly positioned on a generous block.

Price: AUCTION THIS SATURDAY \$690,000 - \$755,000



John Gioftsidis
0410 522 195
john.g@lovere.com.au

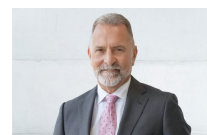

Roger Pettinella
0418 588 419
roger.p@lovere.com.au



GROUND FLOOR

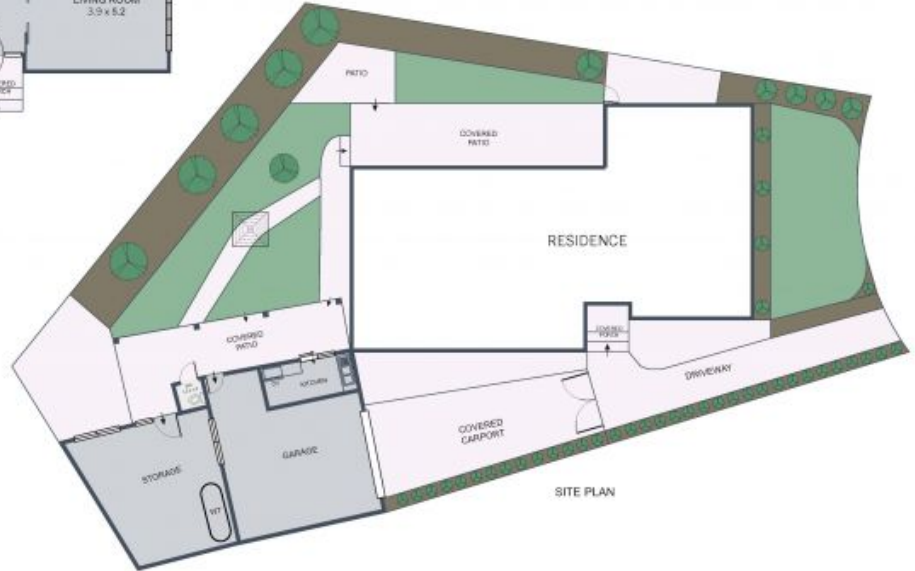

SITE PLAN

Every precaution has been taken to verify the accuracy of the above details. However, prospective purchasers are advised to make their own enquiries.