



110 Northumberland Drive Epping, VIC



BEAUTIFUL HOME IN A PRIME LOCATION

This well-presented family home is ideally located in one of Epping's most convenient pockets, perfect for those who love to entertain and enjoy comfortable living.

The home features:

- ? Three generous bedrooms, including a master with walk-in robe and ensuite
- ? Central main bathroom and separate toilet
- ? Light-filled front lounge
- ? Renovated kitchen overlooking a spacious open-plan family/meals area
- ? Impressive undercover entertainment area
- ? Double garage with drive-through access
- ? Landscaped gardens and a low-maintenance backyard

Price: \$550 per week



Surendra Subedi

loveepping@mail.inspectrealestat

Floor Plan



Site Plan

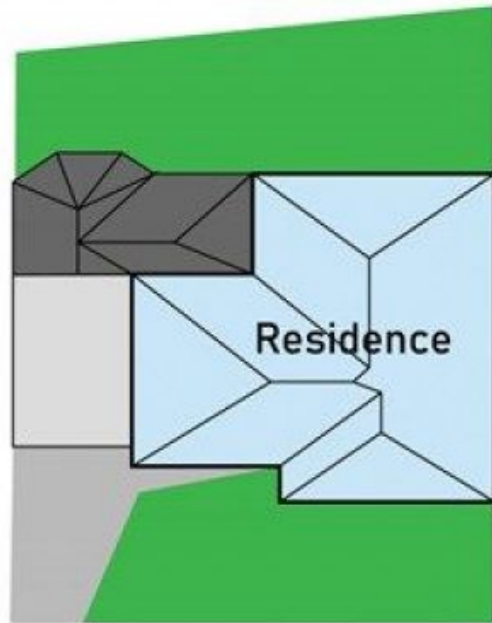

110 Northumberland Drive, Epping

* Dimensions are approximate and for illustrative purposes only

LOVE & CO

110 Northumberland Drive

Epping, VIC