

16 Royston Close Mill Park, VIC

3 1 2

Perfect First Home, Ultimate Investment

This charming home with a convenient address and large block offers limitless scope for the first home buyer and investor. Commanding a wide frontage, this brick veneer beauty is bright and spacious with three bedrooms, comfortable lounge, kitchen with adjoining meals area and central bathroom with separate toilet. The rear yard offers an abundance of space to nurture your imagination with a large veranda, garden shed, double carport and still plenty of space to spare. This is an unbeatable opportunity to secure a sturdy home on a large land parcel only moments to schools, shops and transport options.

This property is currently leased to an excellent renter for \$2,173 pcm (\$500pw).

Price: AUCTION THIS SATURDAY \$650,000 - \$695,000



John Gioftsidis

0410 522 195
john.g@lovere.com.au

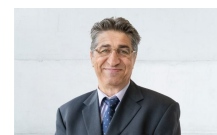

Jim Vasiliou

0418 123 054
jim.v@lovere.com.au



GROUND FLOOR

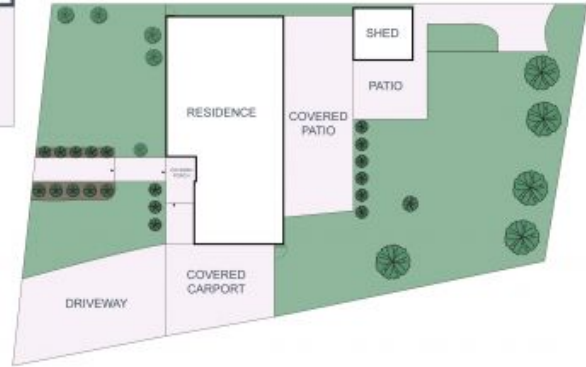

SITEPLAN

Every precaution has been taken to verify the accuracy of the above details. However, prospective purchasers are advised to make their own enquiries.