

24 Brossard Road Mickleham, VIC

 3

 2

 2

### Contemporary Design, Open Plan

Discover the perfect blend of comfort and convenience in this inviting property, tailor-made for both first-time homeowners and savvy investors. Nestled within walking distance to Annadale Park and Tennis courts, and conveniently serviced by bus routes along Ellscott Boulevard, this home offers unparalleled accessibility.

Boasting a youthful demeanour, the residence features three bedrooms, including a master retreat complete with an ensuite and built-in robes, while the remaining bedrooms share a central bathroom. The heart of the home is an expansive open-plan living area, seamlessly integrating meals and family spaces, complemented by a contemporary kitchen adorned with sleek stainless steel appliances.

**Price:** SOLD - \$585,000



**Jim Kalakias**

0402 177 336  
jim.k@lovere.com.au



**Ibbby Zayat**

0466 261 130  
ibby.z@lovere.com.au

# 24 Brossard Road, Mickleham



Floor Plan

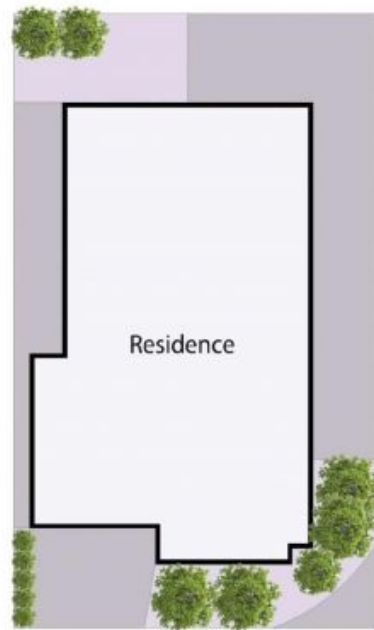

Site Plan

THE ABOVE PLAN IS AN ARTIST'S IMPRESSION ONLY. IT INCLUDES ELEMENTS THAT ARE FOR DISPLAY PURPOSES ONLY AND MAY NOT BE TO SCALE. LANDSCAPING SHOWN IS INDICATIVE ONLY. DIMENSIONS ARE APPROXIMATE.

