



22 Samuel Drive Campbellfield, VIC

3

1

4

"Your Perfect Family Haven Awaits!"

Discover your dream home in this beautifully presented triple-front brick residence! Set on a flat 546 sqm block, it boasts three spacious bedrooms and a central passage leading to a modern timber kitchen with electric hot plates and ample storage. Enjoy the expansive lounge and dining areas, along with ducted heating and a wall-mounted cooler for year-round comfort. The central tiled bathroom and covered front veranda add to the charm. With a side drive to a double carport and double-length garage, this home offers everything you need!

Located within close proximity to Merri Creek parklands , local schools shopping centres and easy access to the western ring road.

Due diligence checklist - for home and residential property buyers
<http://www.consumer.vic.gov.au/duediligencechecklist>

Price: SOLD - \$645,000



Frank Romeo
 0438 010 974
 frank.r@lovere.com.au



Marc Romeo
 0438 100 781
 marc.r@lovere.com.au

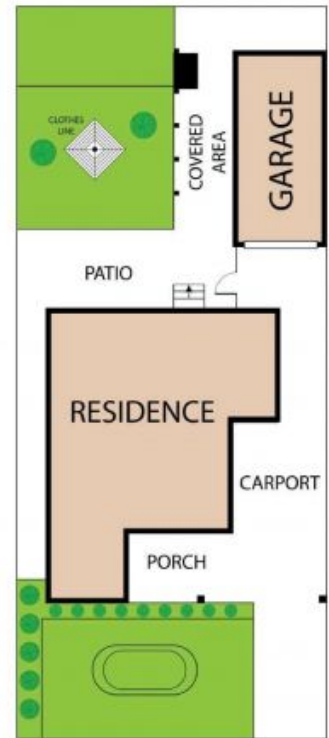

22 Samuel Drive, Campbellfield 3061
TOTAL APPROX. FLOOR AREA 144 SQ.M

Whilst every attempt has been made to ensure the accuracy of the floor plan contained here, measurements of doors, windows, rooms and any other items are approximate and no responsibility is taken for any error, omission, or misstatement. This plan is for illustrative purposes only and should be used as such by any prospective purchaser.