



15 Dransfield Way Epping, VIC

3

1

**Brilliant Start or Investment**

SET NEGTIATION: Wednesday 12th March @ 5:00pm

**Price:** \$550,000 - \$600,000

This three bedroom home on a generous allotment delivers a fabulous entry point for first home buyers, or an equally attractive addition to your investment portfolio. Astute buyers can make the most of an affordable opportunity in a sought after pocket central, Westfield Plenty Valley and the station and enjoy sought after comfort and convenience, with the option of undertaking further updates or even an extension or further additions into the huge yard. (STCA)

- ? Fully renovated bathroom
- ? Heating and cooling
- ? Shed
- ? Large undercover entertaining area
- ? Abundant off-street parking



**John Gioftsidis**

0410 522 195  
john.g@lovere.com.au



**Roger Pettinella**

0418 588 419  
roger.p@lovere.com.au

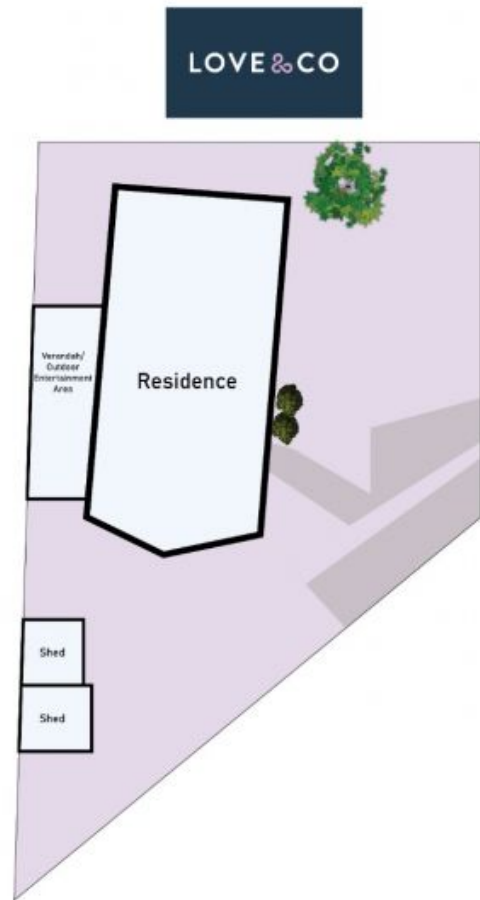
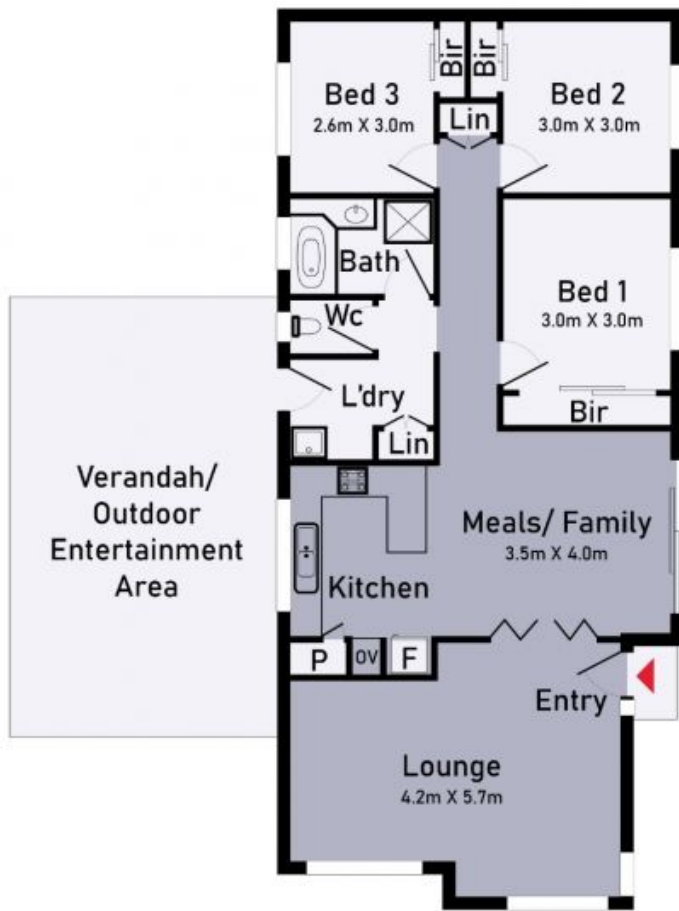

**15 Dransfield Way, Epping**

\* Dimensions are approximate and for illustrative purposes only



**LOVE & CO**

**15 Dransfield Way**

**Epping, VIC**