



12/29 Ardsley Circuit Craigieburn, VIC



2



1



1

Convenient Location

* Sale by Set Negotiation - Offers close Monday, 17th February at 6pm *

This neat and well-designed 2-bedroom townhouse offers a practical yet stylish living space, perfect for first-home buyers, small families, or investors. The two spacious bedrooms come with built-in robes, while the central bathroom offers both convenience and comfort.

The heart of the home is the open plan living and dining area, designed to accommodate modern living. The kitchen features quality stainless-steel appliances and plenty of storage space, while the split system ensures a comfortable climate year-round.

Outside, a single-car garage provides secure parking, and the low-maintenance outdoor area offers a peaceful spot to unwind.

Price: SOLD - \$401,500



Jim Kalakias

0402 177 336
jim.k@lovere.com.au



Ibby Zayat

0466 261 130
ibby.z@lovere.com.au

12/29 Ardsley Circuit, CRAIGIEBURN

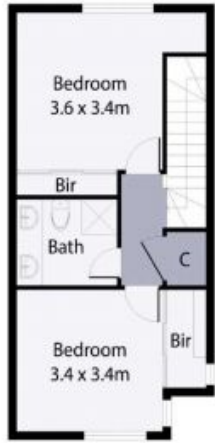

Upstairs

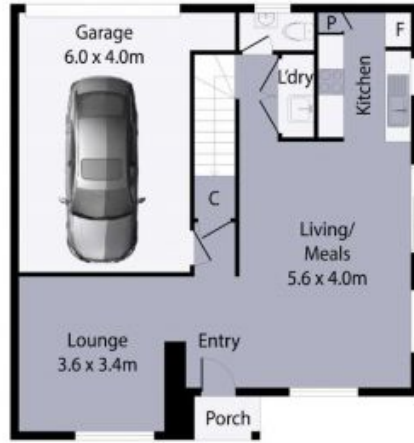

Downstairs

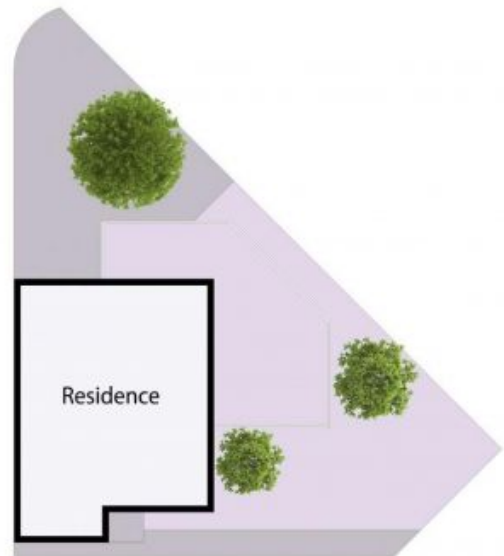

Site Plan

THE ABOVE PLAN IS AN ARTIST'S IMPRESSION ONLY. IT INCLUDES ELEMENTS THAT ARE FOR DISPLAY PURPOSES ONLY AND MAY NOT BE TO SCALE. LANDSCAPING SHOWN IS INDICATIVE ONLY. DIMENSIONS ARE APPROXIMATE.

