



2A Stillman Drive Mill Park, VIC



**"WALK TO EVERYTHING"**

Set Negotiation: Friday 31st January @ 5pm (unless sold prior)

**Price:** Under Contract

Literally a stone's throw from Westfield shopping centre is this lovely town home comprising 3 bedrooms (one downstairs, two upstairs), 2 way bathroom, 2 living areas and double lock up garage.

More than a house than a town home it has enormous potential to value add by simply giving it a paint and doing some basic landscaping.

Make this your perfect home in a very desirable location.

Public places and other facilities which are within walking distance include South Morang train Stain at Westfield, Rivergum Shops, bus stop, Stables Shops, mill park library and Plenty Road Arterial.



**John Gioftsdis**

0410 522 195  
john.g@lovere.com.au



**Jim Vasiliou**

0418 123 054  
jim.v@lovere.com.au

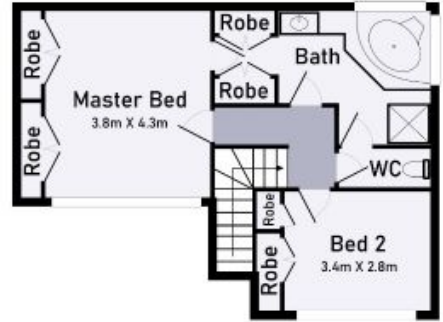

**2A Stillman Drive, Mill Park**

\* Dimensions are approximate and for illustrative purposes only



**2A Stillman Drive**

**Mill Park, VIC**