



3 Manuka Court Mill Park, VIC



Complete Comfort, Absolute Convenience

Spotless and spacious, this magnificent three bedroom home sits on a generous allotment and offers relaxed family living in a perfect family location.

Blending perfect position and proportions, Plenty Parklands Primary, Blossom Park Kindergarten and the bus are just around the corner, whilst The Stables, Uni Hill, RMIT and the tram are all within easy reach.

With freshly polished timber floors underfoot, the home features an expansive formal living and dining zone, whilst a solid timber galley kitchen overlooks a generous meals/family space. Each of the three-bedroom and two bathrooms are zoned at the rear of the home for total privacy.

Price: Sold \$799,000



John Gioftsidis
0410 522 195
john.g@lovere.com.au

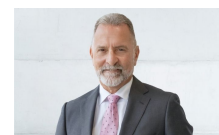

Roger Pettinella
0418 588 419
roger.p@lovere.com.au

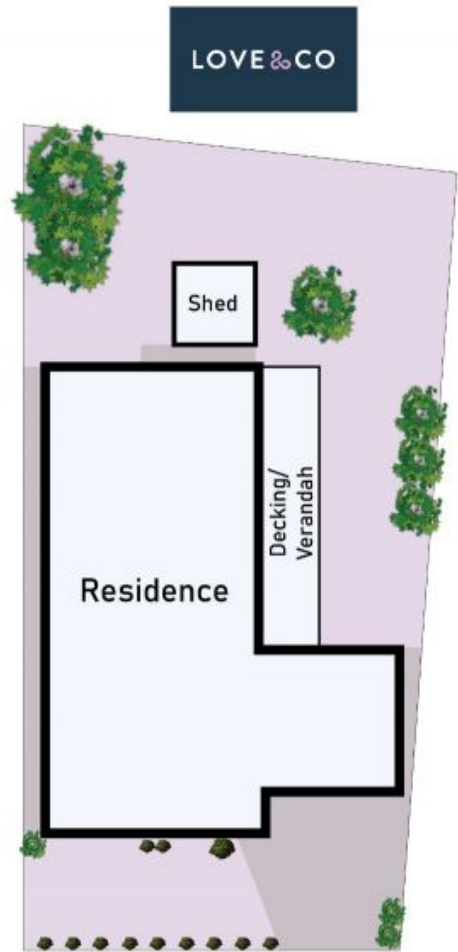
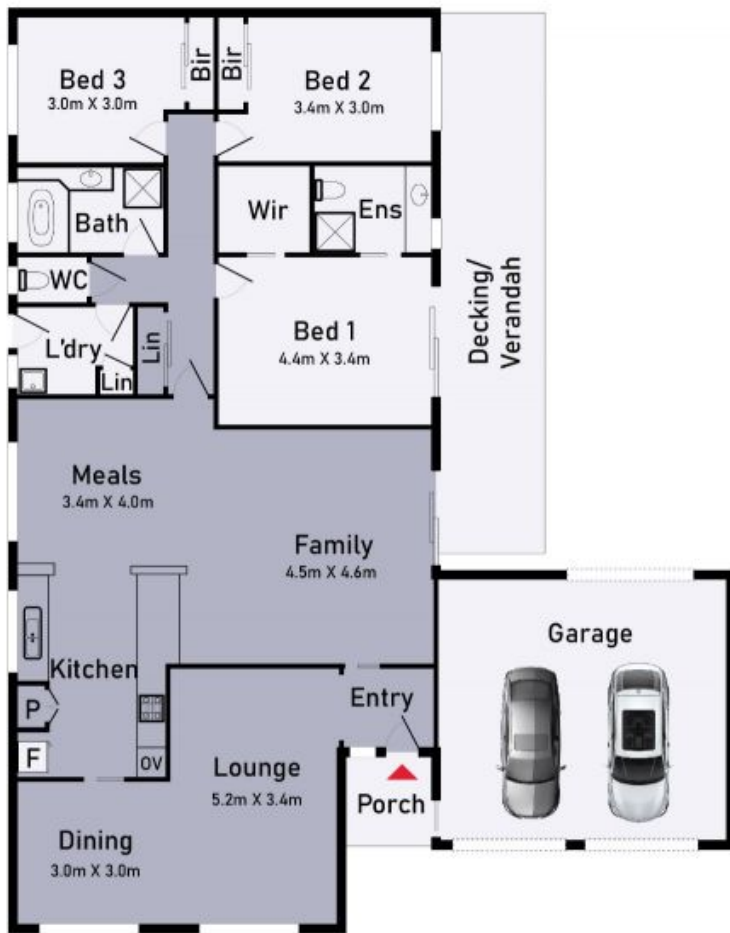

3 Manuka Court, Mill Park

* Dimensions are approximate and for illustrative purposes only



LOVE & CO

3 Manuka Court

Mill Park, VIC