

Suite 4/314-360 Childs Road Mill Park, VIC

AFFORDABLE PROFESSIONAL MILL PARK OFFICE SPACE.

Price: \$190,000

3 partitioned rooms- 48sqm- great space.

First floor office suite located directly inside the Stables Shopping Centre, Mill Park. Superbly presented, professional office suite with floorboards, heating/cooling, NBN, good natural light, communal kitchen and toilets. Strong neighbouring businesses, Real Estate Agents, Solicitors, Accountants.

"The Stables" is a busy shopping centre anchored by Woolworths, Pizza Hut Burgertory and Plough Inn Hotel, with a huge range of specialty shops, medical and pharmacy in the centre.

A Strategic, affordable business location in Melbourne's growing outer northern suburbs.



Anwar Kattan
0431 169 844
anwar.k@lovere.com.au



Branko Agatanovic
0448 035 565
branko.a@lovere.com.au

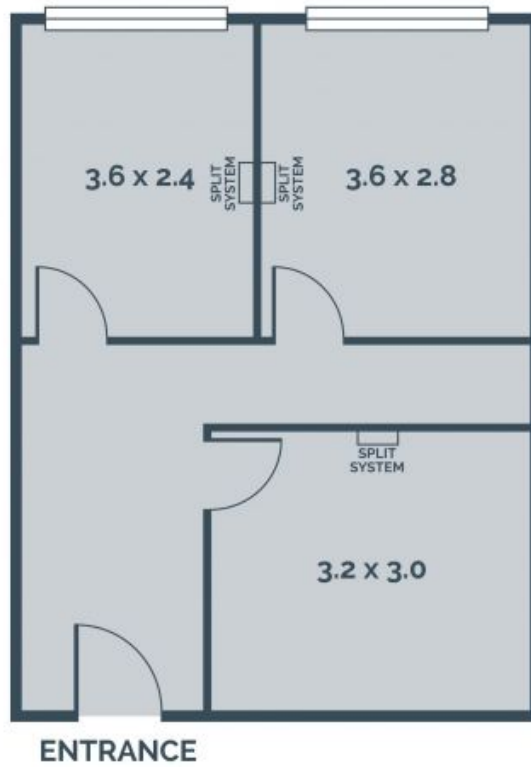

Every precaution has been taken to establish accuracy of the information in this brochure but does not constitute any representation by the vendor or agent.

LOVE & CO

LOVE & CO

Suite 4/314-360 Childs Road

Mill Park, VIC