

105/90 Epping Road Epping, VIC

 1
  1
  1

Stylish & Surprisingly Spacious Apartment

Ideal for downsizers, couples, astute investors and first home buyers, a fantastic opportunity to secure a one bedroom apartment located on the edge of the building with only one side neighbour in Waratah Gardens overlooking Epping Road.

Offering stylish and spacious design for the whole family to enjoy.

Featuring a contemporary kitchen with stone bench tops and quality stainless steel appliances that are integrated in to the open living and meals area, which opens out to a spacious balcony that will surely have you entertaining family and friends all year round.

A large bedroom with mirrored robes, large bathroom complete with shower and bath.

Further living amenities include split system heating & cooling, secure undercover parking space, lockup cage and off-street guest parking.

Price: \$308,500



Bijan Rahimi

0451 515 301
bijan.r@lovere.com.au



Ibby Zayat

0466 261 130
ibby.z@lovere.com.au

105/90 epping Road, Epping

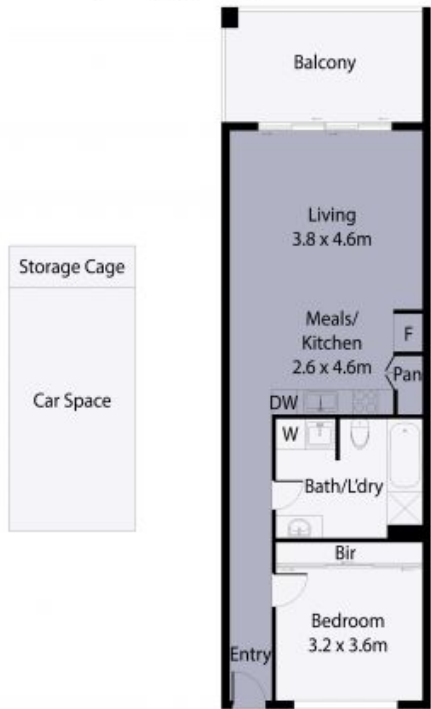

THE ABOVE PLAN IS AN ARTIST'S IMPRESSION ONLY, IT INCLUDES ELEMENTS THAT ARE FOR DISPLAY PURPOSES ONLY AND MAY NOT BE TO SCALE. LANDSCAPING SHOWN IS INDICATIVE ONLY. DIMENSIONS ARE APPROXIMATE.

