



23 Grevillia Drive Mill Park, VIC



The Perfect Place In The Perfect Position

Secure a sought-after slice of marvellous Mill Park within the Blossom Park Estate with this perfectly presented three bedroom home that offers an enjoyable, relaxed, private and convenient indoor/outdoor living lifestyle.

Flawlessly presented this property features a functional floorplan which includes glossy timber floors new carpet underfoot throughout a floorplan that is zoned around a spacious L-shaped lounge/dining area and a galley kitchen with adjoining meals space.

Step outside to a covered alfresco area providing a peaceful and private setting ideal for all weather enjoyment with family and friends.

Adding to the appeal is secured car accommodation for multiple vehicles with easy access through the secure roller door which extends through to the rear providing additional room for a boat, trailer, or extra cars or just for the kids to ride their bikes and scooters.

Price: Sold \$783,000



John Gioftsidis

0410 522 195
john.g@lovere.com.au

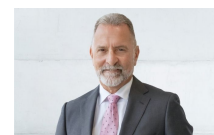

Roger Pettinella

0418 588 419
roger.p@lovere.com.au

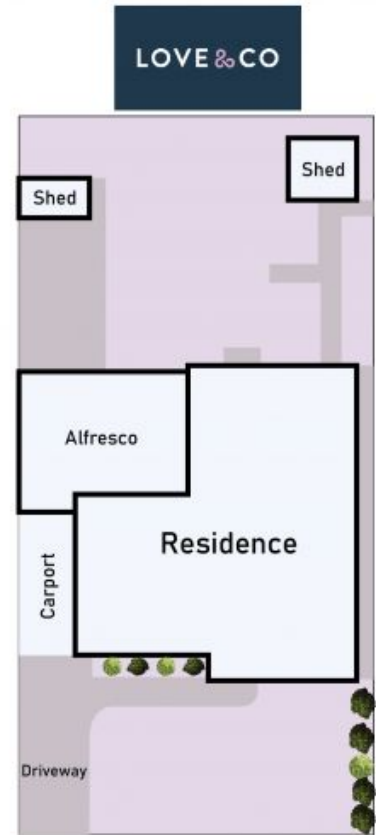
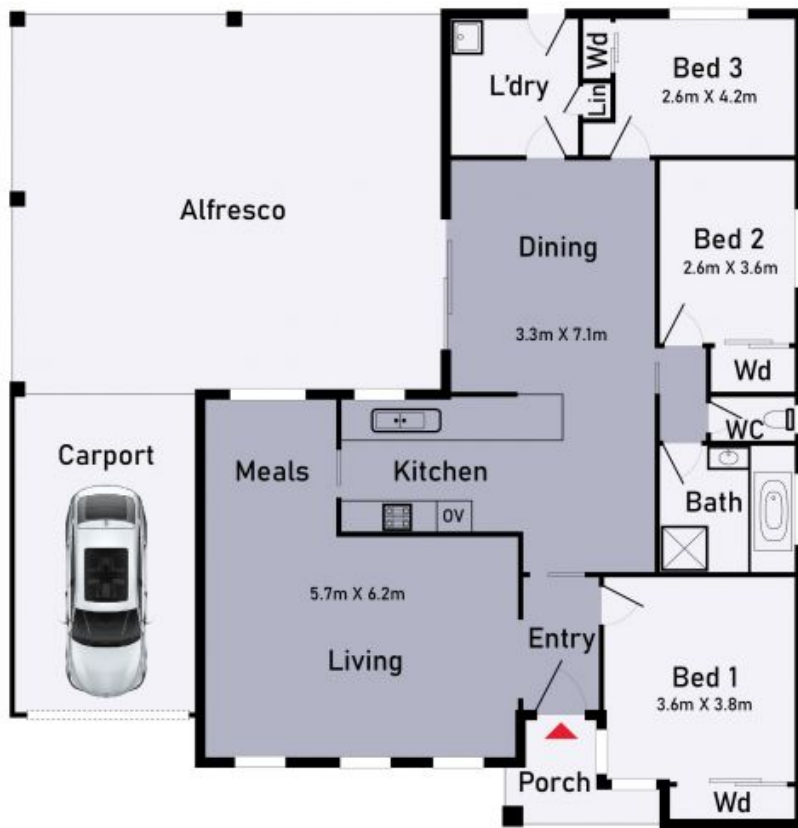

23 Grevillia Drive, Mill Park

* Dimensions are approximate and for illustrative purposes only



LOVE & CO

23 Grevillia Drive

Mill Park, VIC