



15/191 Gordons Road South Morang, VIC



### Primly Positioned For Lifestyle Ease

Experience the perfect blend of quality and convenience in this modern townhouse, ideally situated in a top-notch location. Boasting a prime street frontage and bathed in northern light, this contemporary home is designed for effortless living. With a bus stop right outside, a P-9 school and childcare just 500 meters away, and Coles and local caf?s nearby, everything you need is within easy reach. Marymede, the train station, and Westfield are also a short drive or bus ride away.

The lower level features formal and casual living spaces, including a sleek stone kitchen with stainless steel appliances and glossy finishes. Sliding doors lead to a private courtyard, seamlessly connecting the home to a double carport. The carport is secure with an auto door and can double as a covered alfresco area when summer arrives.

Upstairs offers two generously sized bedrooms, each with its own full ensuite, ensuring both comfort and privacy.

**Price:** Sold \$532,000



**John Gioftsidis**

0410 522 195  
john.g@lovere.com.au

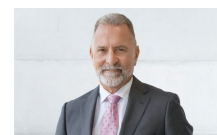

**Roger Pettinella**

0418 588 419  
roger.p@lovere.com.au

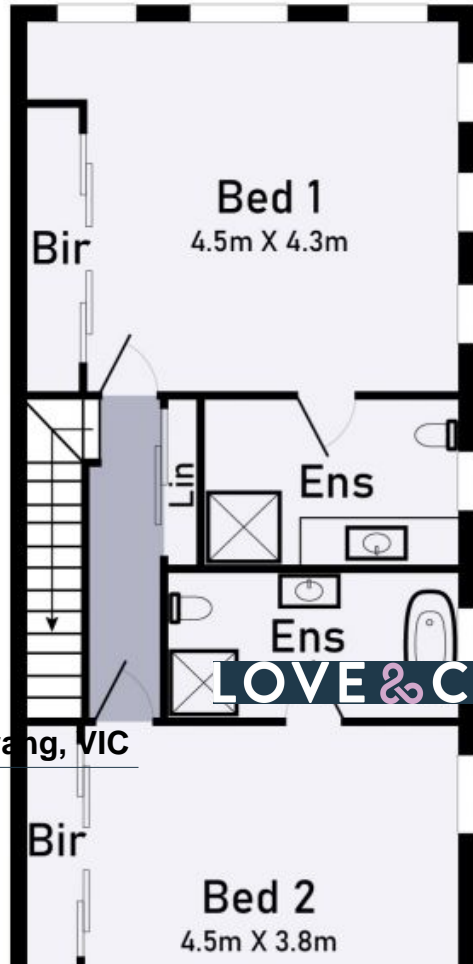
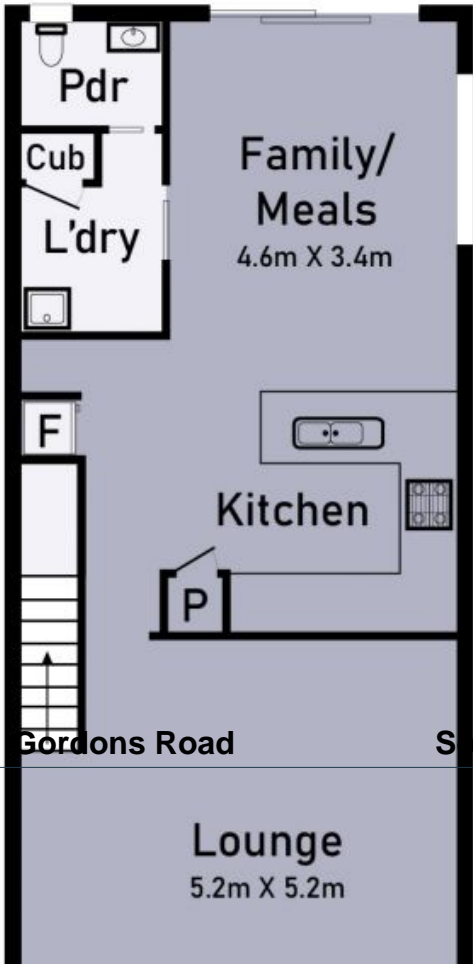

15/191 Gordons Road

South Morang, VIC

