



10 Richhaven Place Epping, VIC



Family-Friendly Modern Townhouse with All the Extras

Welcome to your dream home—a stunning modern townhouse that perfectly blends comfort and style. This spacious residence features three bedrooms, including a luxurious master suite with a walk-in robe and ensuite, while the other two bedrooms offer built-in robes for ample storage.

The heart of the home is the sophisticated kitchen, equipped with stainless steel cooking appliances and a dishwasher, seamlessly flowing into the inviting meals and living zones. These areas overlook the outdoor decking area which features built-in seating, making it ideal for entertaining.

Downstairs the home showcases stylish floorboards, while upstairs offers carpeted bedrooms and a versatile living zone that can serve as a home office or relaxed retreat for children.

Price: \$585,000



Jim Kalakias
0402 177 336
jim.k@lovere.com.au



Ibby Zayat
0466 261 130
ibby.z@lovere.com.au

10 Richhaven Place, Epping

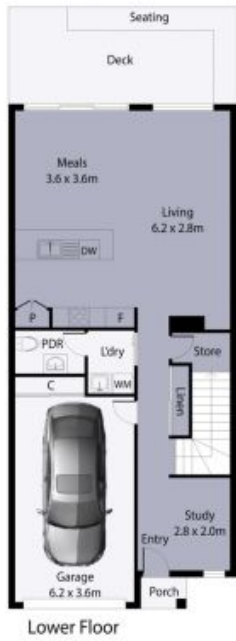

THE ABOVE PLAN IS AN ARTIST'S IMPRESSION ONLY, IT INCLUDES ELEMENTS THAT ARE FOR DISPLAY PURPOSES ONLY AND MAY NOT BE TO SCALE. LANDSCAPING SHOWN IS INDICATIVE ONLY. DIMENSIONS ARE APPROXIMATE.

