



14 Kiewa Street Clifton Hill, VIC



2



1

Victorian Charm Near Yarra Bend Park!

Step inside the stylish spaces of this exceedingly private two bedroom Victorian and discover a surprising low-maintenance lifestyle. Flanked front and back by private and alfresco gardens, this delightful home boasts light, space and period charm in spades. Traditional bedrooms share a skylit bathroom and open plan living with its huge windows and hardwood floors features a quality-appointed kitchen that links to alfresco entertaining with right-of-way offering potential off-street parking. Near cafes, parks and transport, inspection will impress.

- ? High modern fence makes a smart first impression
- ? Master bedroom with French doors to a front deck & gardens
- ? Sunlit open plan living opens to private alfresco gardens
- ? Quality appliances in a chic kitchen with generous storage
- ? Heating/cooling and ROW access offering potential OSP
- ? Walk to Clifton Hill Station, Yarra Bend Park & local cafes

Price: \$750 Per Week



Charlotte Rutter



Charlotte Rutter

charlotte.r@lovere.com.au

charlotte.r@lovere.com.au

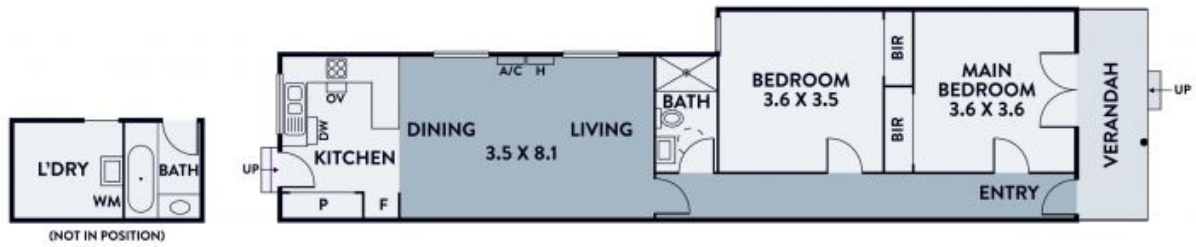

Every precaution has been taken to establish accuracy of the information in this brochure but does not constitute any representation by the vendor or agent.