



3 Tova Court Epping, VIC



### Entertainer's Dream Home

Nestled in a peaceful cul-de-sac, this residence presents a prime opportunity, conveniently situated between two major shopping hubs-Westfield Plenty Valley and Pacific Epping -while also benefiting from proximity to two train stations, Epping and South Morang.

Whether you're a first-time buyer or an astute investor, this home offers the perfect blend of architectural flair, abundant natural light, and versatile living spaces to accommodate the needs of your family.

Comprising three bedrooms, the master suite boasts a luxurious full ensuite and a built-in robe, while the remaining two bedrooms, also featuring built-in robes, share a central bathroom.

The heart of this abode lies within its spacious kitchen, which seamlessly integrates a large meals area with a living space. This area extends effortlessly to a substantial pergola, providing an ideal setting for year-round entertaining, come rain or shine.

**Price:** \$690,000



**Jim Kalakias**

0402 177 336  
jim.k@lovere.com.au



**Ibby Zayat**

0466 261 130  
ibby.z@lovere.com.au

# 3 Tova Court, Epping

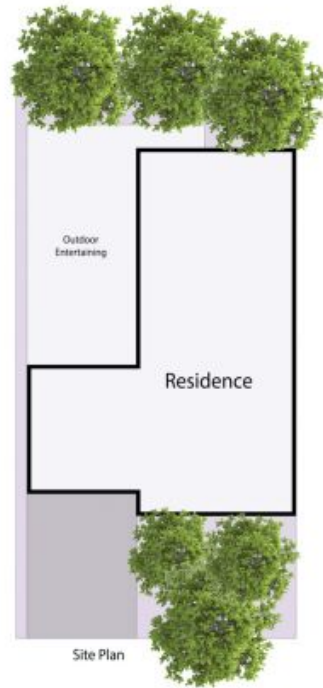

THE ABOVE PLAN IS AN ARTIST'S IMPRESSION ONLY, IT INCLUDES ELEMENTS THAT ARE FOR DISPLAY PURPOSES ONLY AND MAY NOT BE TO SCALE. LANDSCAPING SHOWN IS INDICATIVE ONLY. DIMENSIONS ARE APPROXIMATE.

