



26 Lehmann Walk Epping, VIC

 2
  1
  2

## LIVE OR INVEST - LOW MAINTENANCE LIVING

Enjoying a fabulous outlook across picturesque Wuchatsch Park, this surprisingly spacious unit/ home will appeal to first time home buyers, young families, savvy investors or those just looking to down size. Perfectly positioned in a convenient lifestyle locale, walking distance to cafes, shops, medical clinic, only minutes to shopping options including LYNDARUM Town Centre and AURORA Village, bus services, short drive to Pacific Plaza Epping Shopping/ Dining/ Entertainment Precinct, Northern Hospital and easy access to major road arterials and the Hume Freeway.

Sleek, stylish and cleverly designed for modern living, this beautifully appointed home is ready to move in and simply enjoy today whilst showcasing an intelligent floor plan to maximise light and space, complimented by a relaxed sophistication.

Features include:

**Price:** Auction Saturday 25th May at 11:30am  
**Inspect:** Tuesday, 21st May 2024 5:30 - 6:00  
 Saturday, 25th May 2024 11:00 - 11:30  
**Auction:** 2024-05-25  
**Details:** 11:30:00



**Ryan Di Natale**

0418 330 587

ryan.d@lovere.com.au

# 26 Lehmann Walk, Epping

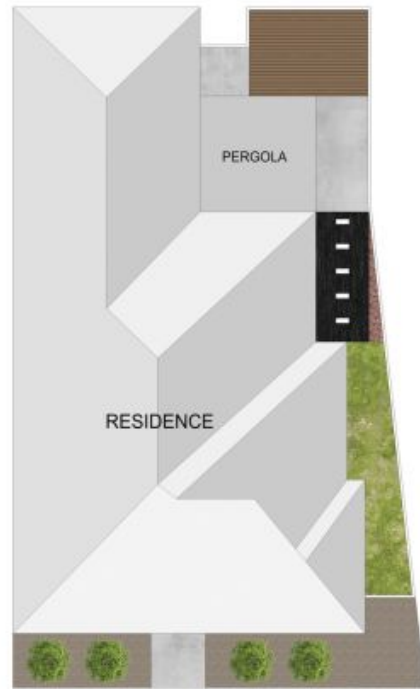

THE ABOVE PLAN IS AN ARTIST'S IMPRESSION ONLY, IT INCLUDES ELEMENTS THAT ARE FOR DISPLAY PURPOSES ONLY AND MAY NOT BE TO SCALE. LANDSCAPING SHOWN IS INDICATIVE ONLY. DIMENSIONS ARE APPROXIMATE.