



35 Foxzami Crescent Epping, VIC

 3
  1
  2

Nest or Invest Family Appeal On 641sqm

Set on a generous allotment in a quiet, yet remarkably convenient position, this instantly-enjoyable residence is enveloped by family-friendly spaces for a fabulous indoor/outdoor lifestyle.

Established gardens and an over-sized driveway frame the front of the home, while an expansive rear yard offers the ideal environment for kids and pets to roam with options aplenty to extend, or perhaps even redevelop (STCA).

The functional layout includes a light-filled formal lounge, well-placed kitchen with expansive meals/family zone and flexible sunroom that offers scope for use as a further living area (rumpus), alfresco zone or even fourth bedroom/study. Three generously sized bedrooms with built-in wardrobes share a central bathroom with a separate bath.

Price: Auction: Sat 11 May @ 11am
Inspect: Saturday, 4th May 2024 12:15 - 12:45
 Wednesday, 8th May 2024 5:30 - 6:00
Auction: 2024-05-11
Details: 11:00:00

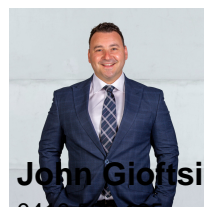

John Giotsidis
 0416 522 195
 john.g@lovere.com.au



Jim Vasiliou
 0418 123 034
 jim.v@lovere.com.au

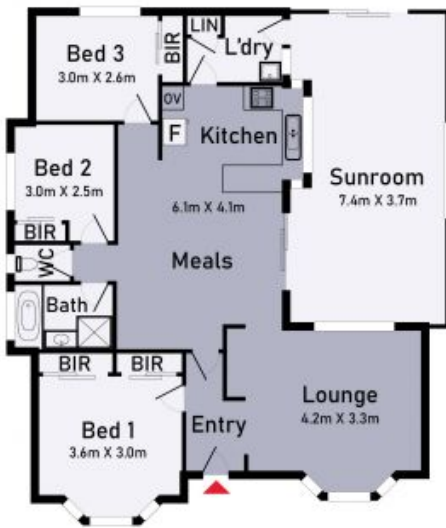
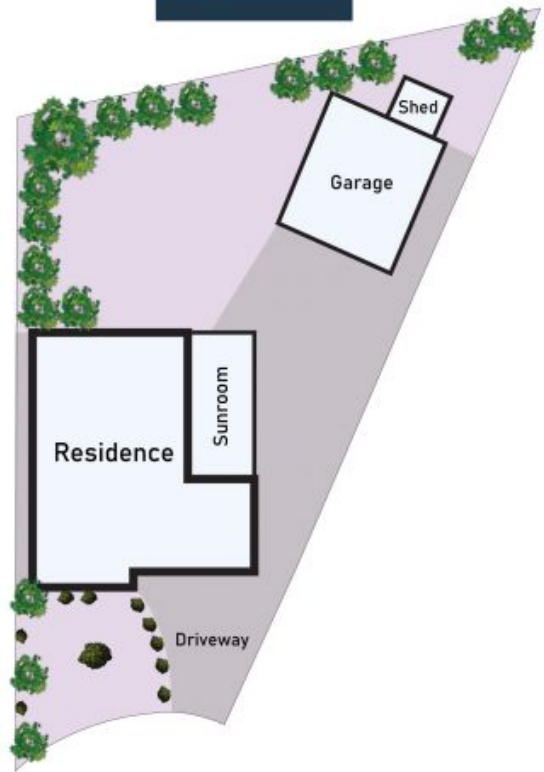

35 Foxzami Crescent Epping

* Dimensions are approximate and for illustrative purposes only

