



4 Cassandra Heights Epping, VIC



Prime Epping Residence

Discover the epitome of comfortable living in the esteemed Lyndarum Estate of Epping. Nestled within this prestigious locale, this impeccably crafted home offers convenience and luxury. Positioned mere minutes away from Epping View Primary, Lyndarum North shops, Plaza, and a bus stop, every essential is at your fingertips.

Step inside to find a meticulously designed layout boasting three generous bedrooms. The master suite exudes elegance with its ensuite and walk-in robes adorned with timber floors, while the remaining bedrooms feature built-in robes for ample storage. The heart of the home lies in the expansive kitchen, complete with an island bench, seamlessly flowing into the open-plan meals and living area, which extends effortlessly to the undercover alfresco zone.

Price: \$782,500



Jim Kalakias

0402 177 336
jim.k@lovere.com.au



Ibby Zayat

0412 469 545
ibby.z@lovere.com.au

4 Kassandra Heights, Epping

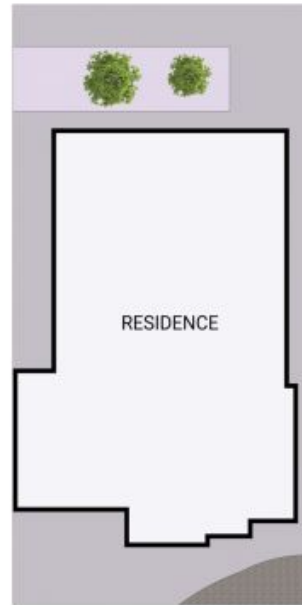

THE ABOVE PLAN IS AN ARTIST'S IMPRESSION ONLY, IT INCLUDES ELEMENTS THAT ARE FOR DISPLAY PURPOSES ONLY AND MAY NOT BE TO SCALE. LANDSCAPING SHOWN IS INDICATIVE ONLY. DIMENSIONS ARE APPROXIMATE.

