



1/66 Widford Street Glenroy, VIC



Lifestyle Location With Laid Back Appeal

Enjoying sought after street frontage and set behind a landscaped front garden, this sleek contemporary town residence is sure to immediately impresses with its generous proportions, premium finishes and delightful street presence.

With the bus almost at the door, Glenroy station and shopping precinct are around the corner and only a short walk away, the lifestyle location is matched by low-maintenance ease in this spacious two-bed townhome. Laid out over two levels, the ground floor offers abundant living and dining spaces, anchored by a kitchen boasting stone waterfall benches and stainless-steel appliances, whilst two first floor bedrooms share a deluxe bathroom.

- ? Garage with auto roller door and rear access
- ? Private entertainers courtyard

Price: \$520,000 - \$560,000

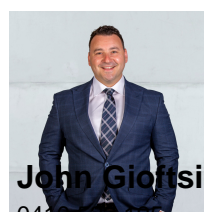

John Giotsidis

0416 522 195
john.g@lovere.com.au



Jordan Knight

0434 969 667
jordan.k@lovere.com.au

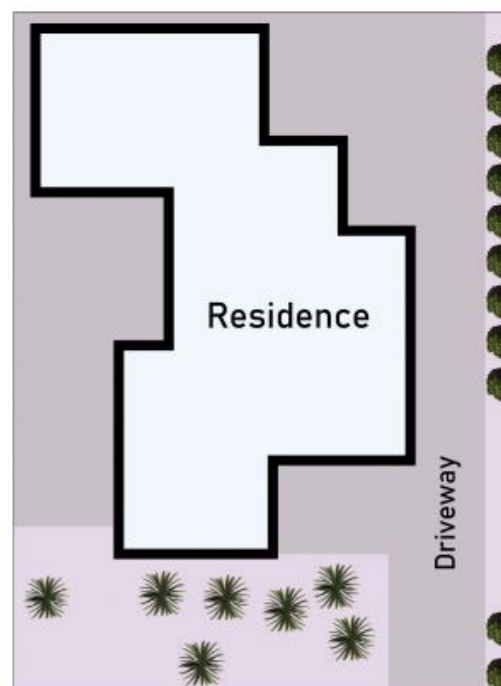
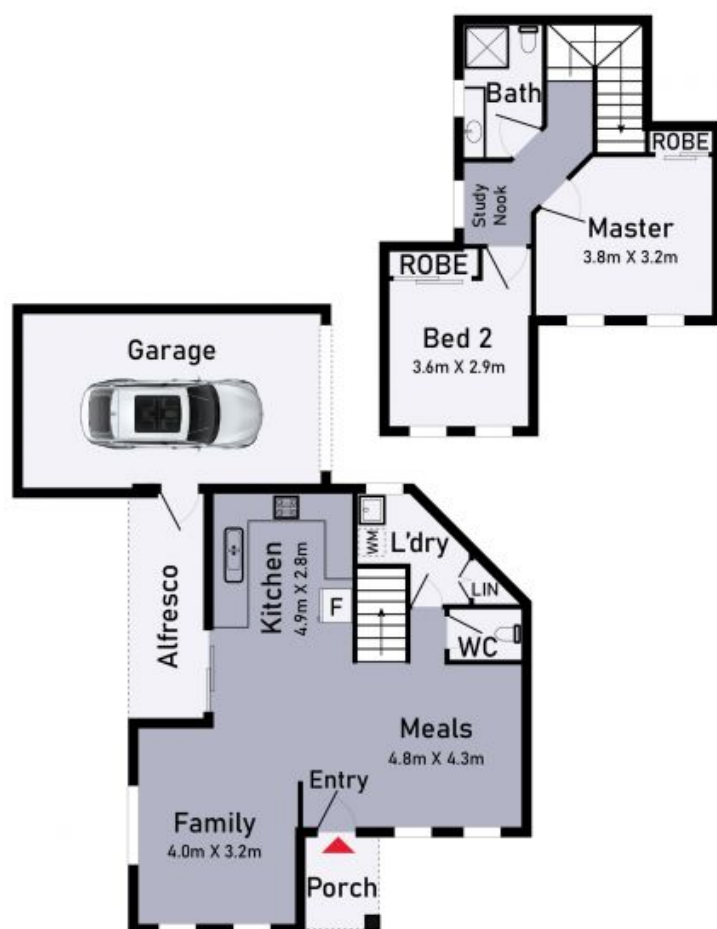

1/66 Widford Street Glenroy

* Dimensions are approximate and for illustrative purposes only



1/66 Widford Street

Glenroy, VIC