



6/1A Hamilton Street Alphington, VIC

2 2 1

Modern Elegance at a Coveted Location

This elegant townhouse, boasting modern and sophisticated finishes, is perfectly nestled in a peaceful cul-de-sac. Constructed with premium Daniel Robertson bricks, it offers a refined contemporary lifestyle within close proximity to the scenic Yarra River, Station St shopping, Fairfield Train Station, the Eastern Freeway, prestigious Alphington Grammar, Fairfield Primary Schools, and numerous golf courses.

Designed with meticulous attention to detail, this exquisite home features two spacious bedrooms with built-in wardrobes, distributed over two levels to ensure utmost privacy. The ground floor bedroom benefits from direct access to a private courtyard, while a convenient study area on the same floor accommodates home office needs.

The residence gleams with polished timber flooring throughout the upper-level open-plan living and dining space, adding to the overall modern elegance. This area extends effortlessly to a chic balcony, perfect for basking in the afternoon sun. The state-of-the-art kitchen overlooks the entertainment space, equipped with stainless steel appliances, including a dishwasher, and is thoughtfully designed for culinary efficiency.

Price: SOLD - \$770,000



Nick Angelopoulos

0410 116 002
nick.a@lovere.com.au



Theo Angelopoulos

0414 813 160
theo.a@lovere.com.au

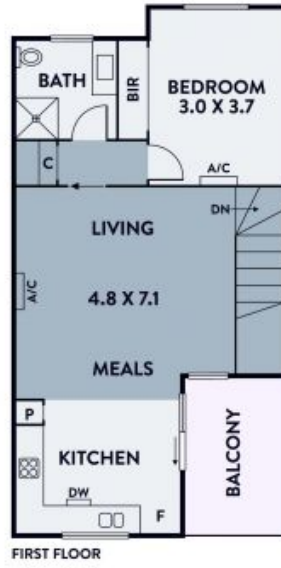
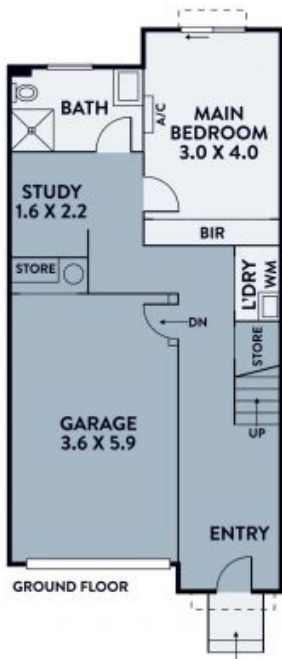

Every precaution has been taken to establish accuracy of the information in this brochure but does not constitute any representation by the vendor or agent.

6/1A Hamilton Street

Alphington, VIC

LOVE & CO