



17 Globe Place Epping, VIC

4 2 3

Luxury Living: Complete Salon Set-Up Included!

Nestled within the tranquillity of a cul-de-sac and exuding unparalleled convenience, this exceptional property awaits its discerning new owner. Perfectly positioned within walking distance to the station, Dalton Village shops, esteemed educational institutions like St. Monica's and NMIT, this residence epitomises both luxury and practicality.

Upon entry, be captivated by the grandeur of cathedral ceilings, adorned with stunning parquetry floors that seamlessly lead to a sunken lounge room, draped in sheer curtains, offering a serene retreat for relaxation and entertainment alike.

Boasting four bedrooms, each adorned with striking parquetry floors, this home exudes sophistication. The master bedroom unveils an awe-inspiring ornate ceiling, accompanied by an en suite/WIR, while the remaining bedrooms are serviced by a spacious central bathroom, ensuring comfort and convenience for every member of the household.

Price: \$1,000,000



Jim Kalakias

0402 177 336
jim.k@lovere.com.au



Ibbby Zayat

0412 469 545
ibby.z@lovere.com.au

17 Globe Place, Epping

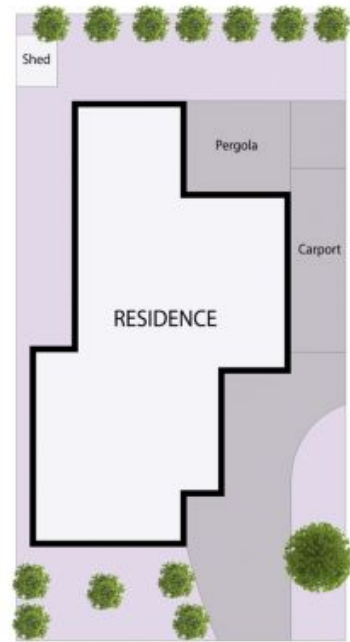
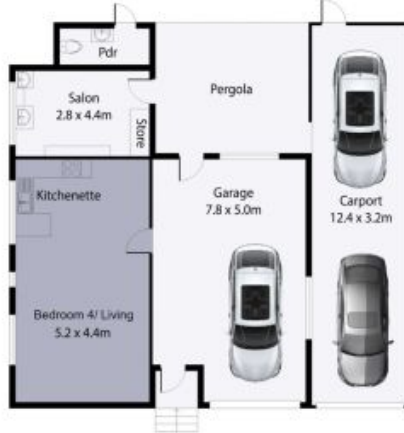

THE ABOVE PLAN IS AN ARTIST'S IMPRESSION ONLY, IT INCLUDES ELEMENTS THAT ARE FOR DISPLAY PURPOSES ONLY AND MAY NOT BE TO SCALE. LANDSCAPING SHOWN IS INDICATIVE ONLY. DIMENSIONS ARE APPROXIMATE.

