

3/20 Livingstone Road Eltham, VIC



Sunny, Spacious & Superbly Located

Superbly positioned in a dynamic locale & with an abundance of natural light, this well maintained, peaceful & private villa unit provides immeasurable lifestyle appeal. Featuring a flowing floor plan with generous proportions, it delivers the space young couples or families need with the single level, low maintenance ease perfectly suited to downsizers & while perfectly move-in-ready. A welcoming entrance flows through to a generous light filled, living & dining area with garden outlook & sliding doors opening out to a sunny rear courtyard, while a well-appointed timber kitchen with plenty of storage & cooking space further complements the living zone. Also comprising three generous bedrooms, a sparkling central bathroom with bath & shower, separate toilet & the added bonus of a generous double garage. Other features include heating/cooling, double garage & full-sized laundry. Conveniently located within walking distance of Eltham Train Station, Eltham Village, a number of local schools including Eltham East Primary and CLC with an abundance of parks and recreation all close-by.

Price: \$550 Per Week



Paige Campbell



Paige Campbell

lovmillpark@mail.inspectrealest.com.au

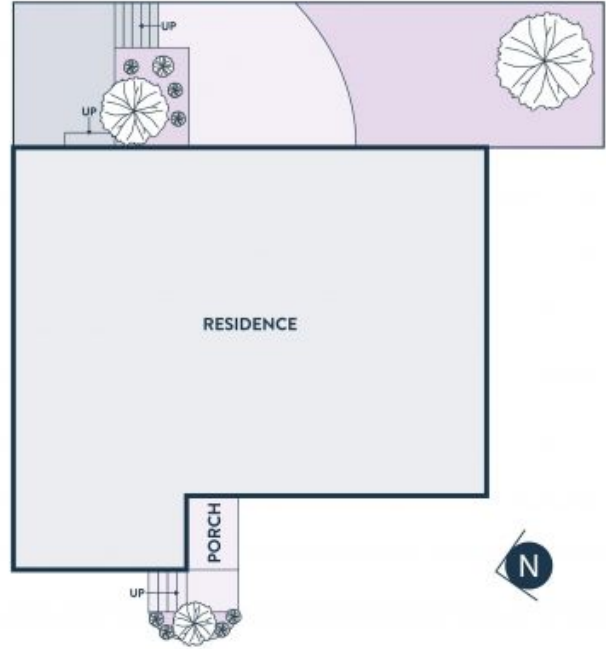

Every precaution has been taken to establish accuracy of the information in this brochure but does not constitute any representation by the vendor or agent.

LOVE & CO

3/20 Livingstone Road

Eltham, VIC