



205/55 Oleander Drive Mill Park, VIC

 2
  2
  1

"TOP FLOOR - GREAT VIEWS"

Ideally positioned, this contemporary apartment presents a high standard of living in a first class location.

Ideal for young professionals wanting to enter the market, downsizers wanting low maintenance living or savvy investors looking for a future proof investment.

An open floor plan with designer finishes, a beautifully appointed kitchen with stone bench, front balcony, basement car park and storage, two good size bedrooms each with a bathroom & light filled living areas make up this wonderful property.

A hassle free lifestyle awaits with cafes literally at your doorstep & Westfield shopping centre & South Morang Train Station only a short stroll away.

Price: \$385,000 - \$405,000
Inspect: Wednesday, 22nd May 2024 5:15 - 5:45



Jim Vasiliou

0418 123 034
jim.v@lovere.com.au



Jordan Knight

0434 969 667
jordan.k@lovere.com.au

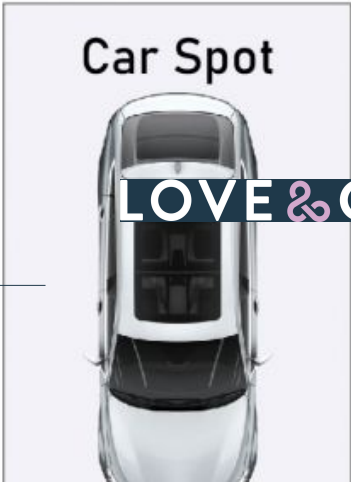
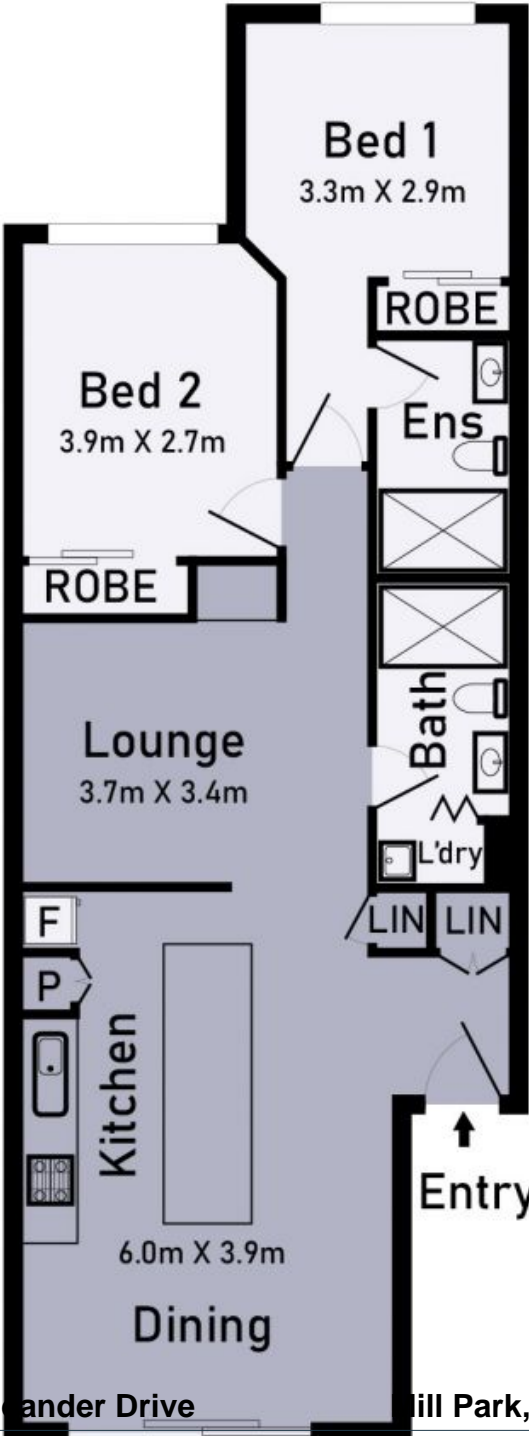

205/55 Oldander Drive Mill Park, VIC

Balcony