



111 Peppercorn Parade Epping, VIC



4



1



2

Ideal Family Home or Investment Opportunity

Nestled in a prime location within walking distance to Greenbrook shops and Greenbrook Primary, and just a short drive to both Plaza and Westfield, this property is perfect for a growing family or savvy investor.

Featuring four bedrooms, this home provides ample space for family living. The tiled floor-to-ceiling bathroom exudes a modern touch, complemented by built-in robes in three bedrooms for added convenience.

The heart of the home boasts a generous lounge/dining area, providing a comfortable space for relaxation and gatherings. The updated kitchen, complete with stainless steel appliances and stone benchtops, is a stylish focal point that seamlessly integrates with a separate meals area.

Price: \$705,000



Jim Kalakias

0402 177 336
jim.k@lovere.com.au



Ibbby Zayat

0412 469 545
ibby.z@lovere.com.au

111 Peppercorn Parade, Epping

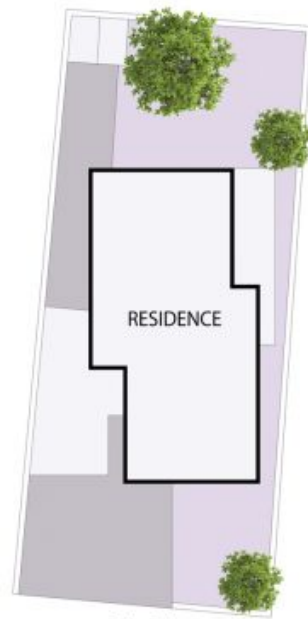

Site Plan

THE ABOVE PLAN IS AN ARTIST'S IMPRESSION ONLY, IT INCLUDES ELEMENTS THAT ARE FOR DISPLAY PURPOSES ONLY AND MAY NOT BE TO SCALE. LANDSCAPING SHOWN IS INDICATIVE ONLY. DIMENSIONS ARE APPROXIMATE.

