



35 Kiama Drive Lalor, VIC



LOOK NO FURTHER

With quality built to last this much loved family home is proudly offered to the market for the first time in over 50 years.

A classic cream brick veneer home that has been fastidiously maintained over the years and showcases an interior that exudes warmth, charm and quality workmanship of a bygone era.

Superbly located in one of the areas favourite and most sought after pockets it is within walking distance to Lalor Train Station, Epping Plaza Shopping Centre, Costco, Northern Hospital and a host of local schools and other forms of public transport.

Comprises formal entry leading to Spacious lounge, 3 good size bedrooms, fully equipped kitchen, meals area and a central bathroom.

Externally the property provides a extra large single garage and a rear yard large enough for the kids to play and grow vegetables in a ready to go veggie patch.

-this one must go on your inspection list.

Price: Sold \$725,000



Jim Vasiliou

0418 123 034
jim.v@lovere.com.au



John Giotsidis

0416 322 135
john.g@lovere.com.au

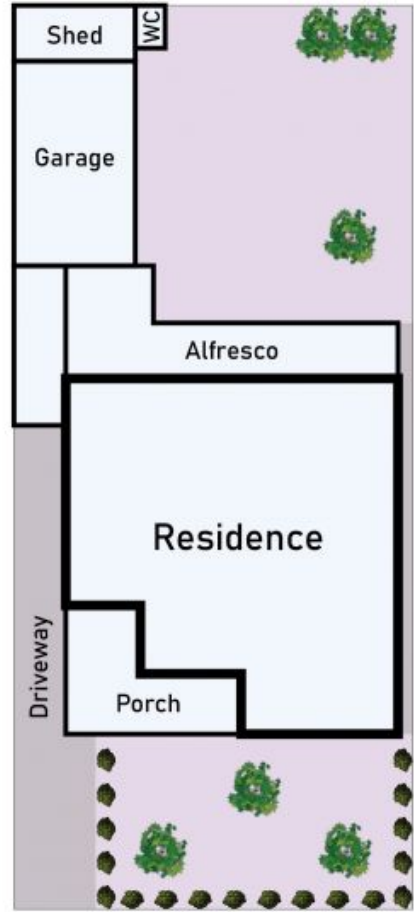
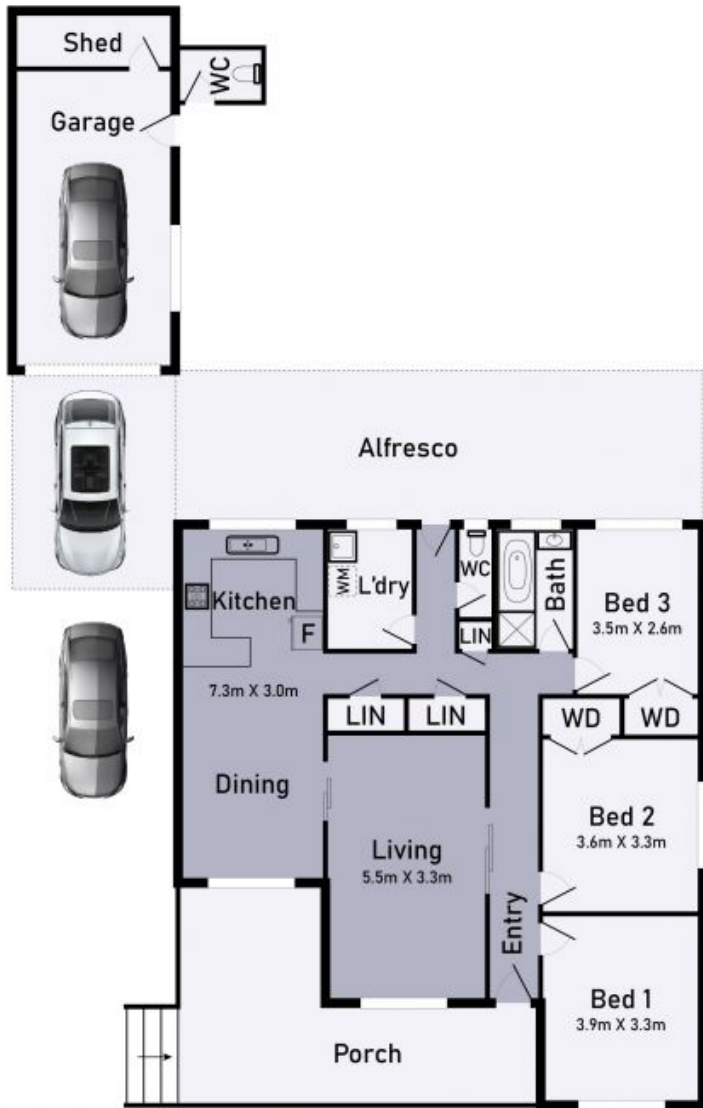

35 Kiama Drive Lalor

* Dimensions are approximate and for illustrative purposes only

