



40 Northumberland Drive Epping, VIC



4



1

### Perfect Blend of Comfort and Accessibility

This meticulously maintained property presents an excellent entry into the real estate market, catering to the discerning tastes of first-time homebuyers and savvy investors alike. Situated within walking distance to the picturesque Darebin Creek trail, and conveniently close to Epping Secondary College and Meadow Glen Primary, this residence offers the perfect blend of tranquillity and accessibility.

Step inside to discover a freshly painted haven featuring four bedrooms, creating ample space for the entire family. The interior boasts two inviting living zones, an updated kitchen, and a modern bathroom, providing comfort and style for everyday living. The charm extends outdoors to a fabulous entertaining area, complemented by a lush grassy space for children to play and a convenient shed for storage needs.

This property also caters to practicalities with a lengthy driveway capable of accommodating multiple vehicles, a caravan, or even a boat. Just a short drive away, choose between the vibrant options at the Plaza or Westfield for delightful movie nights or dinners out. Seize the opportunity to make this residence your own - a perfect blend of comfort, conveni

**Price:** Sold At Auction



**Jim Kalakias**

0402 177 336  
jim.k@lovere.com.au



**Ibby Zayat**

0412 469 545  
ibby.z@lovere.com.au

# 40 Northumberland Drive, Epping

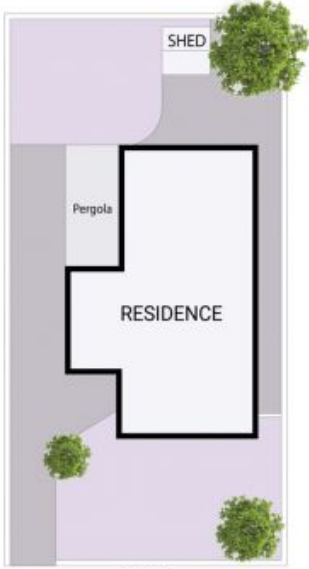

THE ABOVE PLAN IS AN ARTIST'S IMPRESSION ONLY, IT INCLUDES ELEMENTS THAT ARE FOR DISPLAY PURPOSES ONLY AND MAY NOT BE TO SCALE. LANDSCAPING SHOWN IS INDICATIVE ONLY. DIMENSIONS ARE APPROXIMATE.

