



25 Newington Parade Mernda, VIC



4



2



2

Versatile Living in Prime Location

Discover the epitome of convenience with this inviting residence, ideally situated a short drive from Mernda Village, Mernda Junction, Mernda Town Centre, and the station. Spoilt for choice, this home is perfectly tailored to suit first-time buyers, investors, or downsizers.

Comprising four bedrooms, the master retreat boasts an ensuite and walk-in robe, offering a touch of luxury and privacy. A sparkling bathroom efficiently services the two additional bedrooms. The spacious living/dining area provides a comfortable and adaptable space for relaxation and entertainment.

The heart of the home is the stone kitchen, complete with stainless steel appliances, including a dishwasher, ensuring both functionality and style. Additionally, a dedicated study/rumpus area adds versatility to the floor plan.

Price: \$767,000



Jim Kalakias

0402 177 336

jim.k@lovere.com.au



Ibby Zayat

0412 469 545

ibby.z@lovere.com.au

25 Newington Parade, Mernda

LOVE & CO

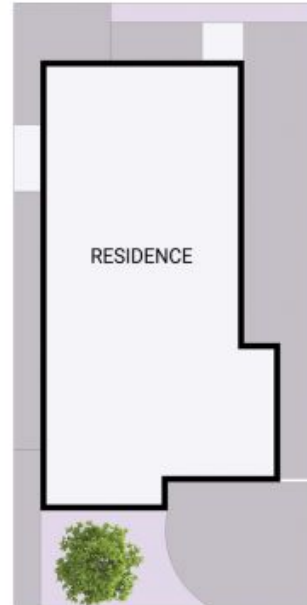

THE ABOVE PLAN IS AN ARTIST'S IMPRESSION ONLY, IT INCLUDES ELEMENTS THAT ARE FOR DISPLAY PURPOSES ONLY AND MAY NOT BE TO SCALE. LANDSCAPING SHOWN IS INDICATIVE ONLY. DIMENSIONS ARE APPROXIMATE.



LOVE & CO

25 Newington Parade

Mernda, VIC