

415/2 Plenty Road Preston, VIC

 1
  1
  1

### Prime Locale, Exceptional Opportunity Awaits

Indulge in the epitome of upscale urban living within Melbourne's vibrant inner north! Unwind in this stylish one-bedroom, one-bathroom apartment nestled in the coveted Gateway Apartments building on the Thornbury fringe. Awash with natural light, revel in the trendy interior boasting a generously sized bedroom with a chic mirrored built-in robe, a modern kitchen adorned with a sleek stone benchtop, and high-end stainless-steel cooking appliances, including a dishwasher.

Entertain seamlessly in the spacious open-plan living area that extends to a fabulous full-width undercover balcony through sliding doors. The apartment's allure is further accentuated by polished timber flooring, discreet internal laundry facilities, a split system for heating and cooling, video intercom, lift access, and secure parking. (not stacker parking)

Situated at the bustling High Street/Plenty Road junction, you're just moments away from chic cafes, restaurants, and bars, with the convenience of the no.86 tram stopping right at your doorstep. Enjoy a leisurely stroll to Thornbury train station and nearby parklands, with easy access to Preston Market, High Street shops, supermarkets, La Trobe

**Price:** SOLD - \$320,000



**Eric Brown**  
0474870856  
eric.b@lovere.com.au



**Theo Angelopoulos**  
0414 813 160  
theo.a@lovere.com.au

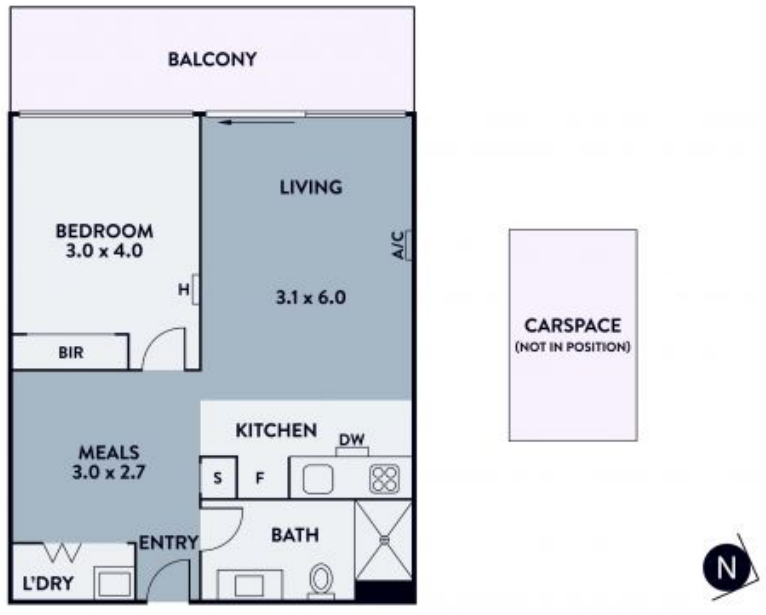

Every precaution has been taken to establish accuracy of the information in this brochure but does not constitute any representation by the vendor or agent.

415/2 Plenty Road

Preston, VIC

