

28 Glendale Avenue Epping, VIC

3

2

2

Glorious Home On Glendale

This three bedroom, two bathroom home is the perfect option for those looking to for easy manageable living. Perfectly presented, the interior offers formal living complementing casual living that stretches out from a stunning kitchen with a timeless combination of black and white and fitted with stainless steel appliances. The main bedroom includes an ensuite, while the remaining bedrooms share a contemporary bathroom featuring bowl vanity, huge frameless glass shower and designer detailing. Ducted heating and cooling ensure year-round comfort, with an expansive covered outdoor area. With a wide driveway leading to a fitted garage, shed and roller shutters leading a list of extras, a glorious opportunity on Glendale awaits.

INSPECTIONS MAY BE CANCELLED UP TO 24 HOURS PRIOR WITHOUT NOTICE. YOU MUST REGISTER TO VIEW THIS PROPERTY AT AN OPEN FOR INSPECTION AND TO BE NOTIFIED OF ANY CHANGES OR CANCELLATIONS

Price: \$585 Per Week

LOVE & CO

LOVE & CO

Vicki Cianci

Vicki Cianci

lovemillpark@mail.inspectrealest

28 Glendale Ave. Epping

Site Plan

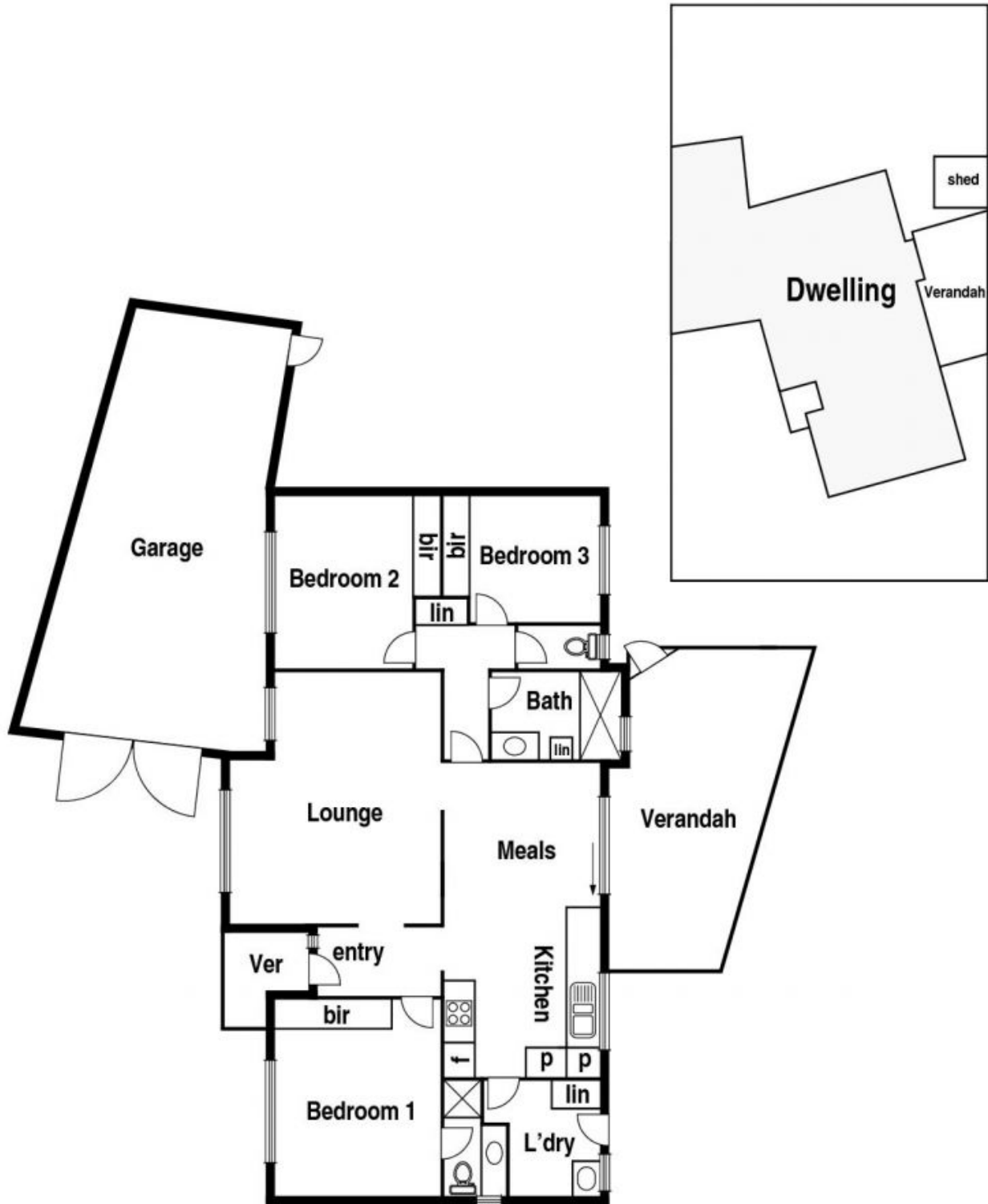

LOVE & CO

The information contained herein has been obtained through sources deemed to be reliable but cannot be guaranteed as to its accuracy. Any information of special interest should be obtained through independent verification.

28 Glendale Avenue Epping, VIC