



16 Maiden Court Epping, VIC



Effortless Living, Inspired Entertaining.
UNDER CONTRACT

Price: Sold

UNDER CONTRACT

With its undeniable street appeal and display home presentation, this enchanting home will immediately delight with a seamless indoor / outdoor connection and its focus on family orientated living.

The light filled interior is wonderfully spacious featuring a huge showcase formal lounge, a superb gourmet timber kitchen with premium appliances, massive bench spaces and cupboards galore, all overlooking the large meals area and a huge sun filled 2nd family living area. Indulge in the lavish master bedroom with a luxurious private ensuite and WIR, 2 further bedrooms and a big study/4th bedroom if need be. A rear yard that delivers a sanctuary for all year entertaining including an undercover pergola with a beautiful waterfall feature, a BBQ gazebo with hot/cold water, an air-conditioned man cave shed that's hard to fault and calming tropical gardens throughout.

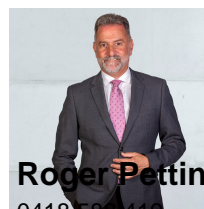

Roger Pettinella
0418 588 419
roger.p@lovere.com.au



John Gioltsidis
0416 522 195
john.g@lovere.com.au

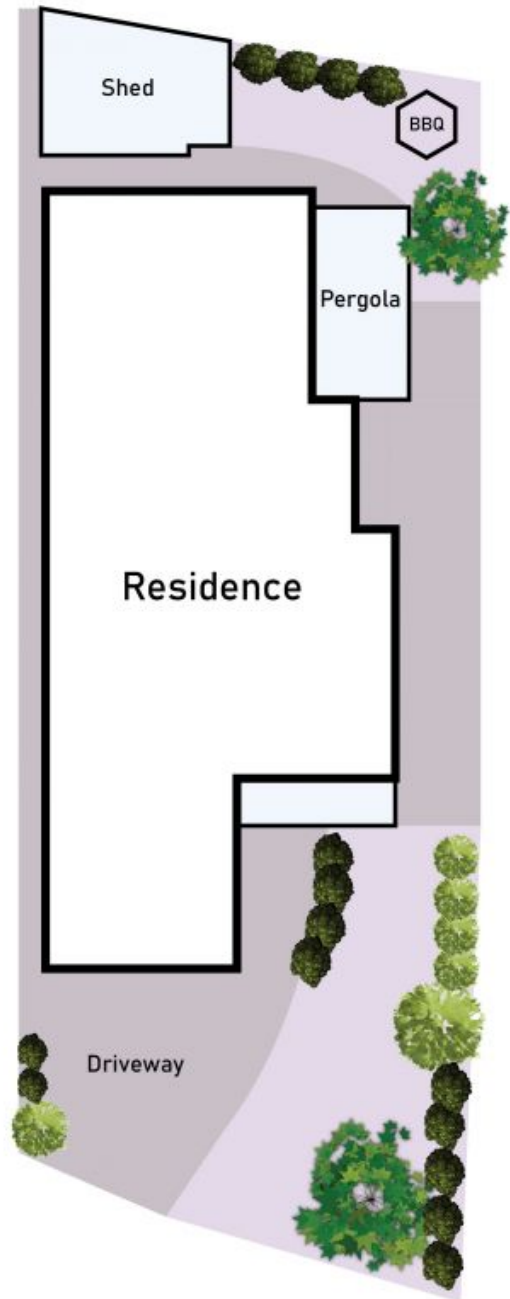
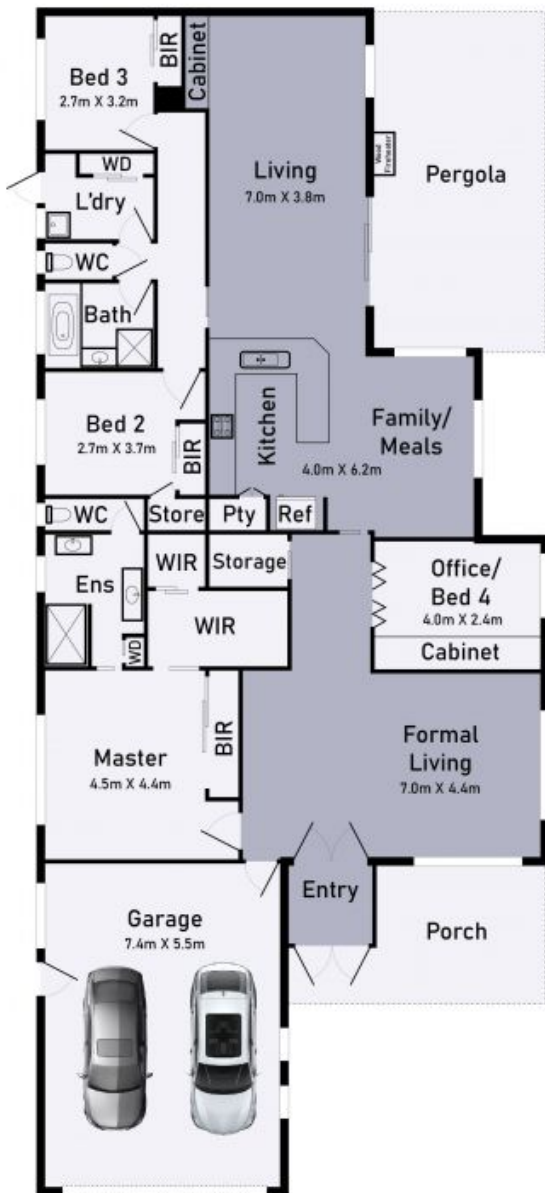
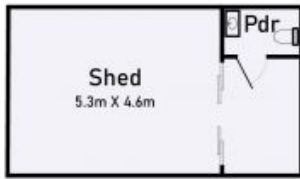

16 Maiden Court Epping

* Dimensions are approximate and for illustrative purposes only



16 Maiden Court

Epping, VIC

