



40 Wedge Street Epping, VIC

 2
  1
  2

Live In The Heart Of All The Action!

If everyday convenience stands at the centre of your world, then this stylishly updated two-bedroom townhouse delivers the perfect lock-up and go lifestyle in the heart of all the action!

Once you close the door behind you, a world of convenience opens up before you. Within moments, you can find yourself shopping and dining along the buzzing local High Street strip or at Epping Plaza Shopping Centre, while living within easy walking distance of Epping train station and local bus services means you can keep your car securely parked in the remote double garage and commute around town via public transport instead! Factor in walking distance access to St Peter's Primary School, Epping Primary School, St Monica's College, Melbourne Polytechnic and the Darebin Creek Trail and the close proximity of the Hume Freeway/Metropolitan Ring Road, Costco and the Northern Hospital and every lifestyle need is comfortably catered for here.

Price: Sold \$570,000

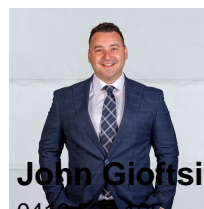

John Giotsidis

0410 522 195

john.g@lovere.com.au

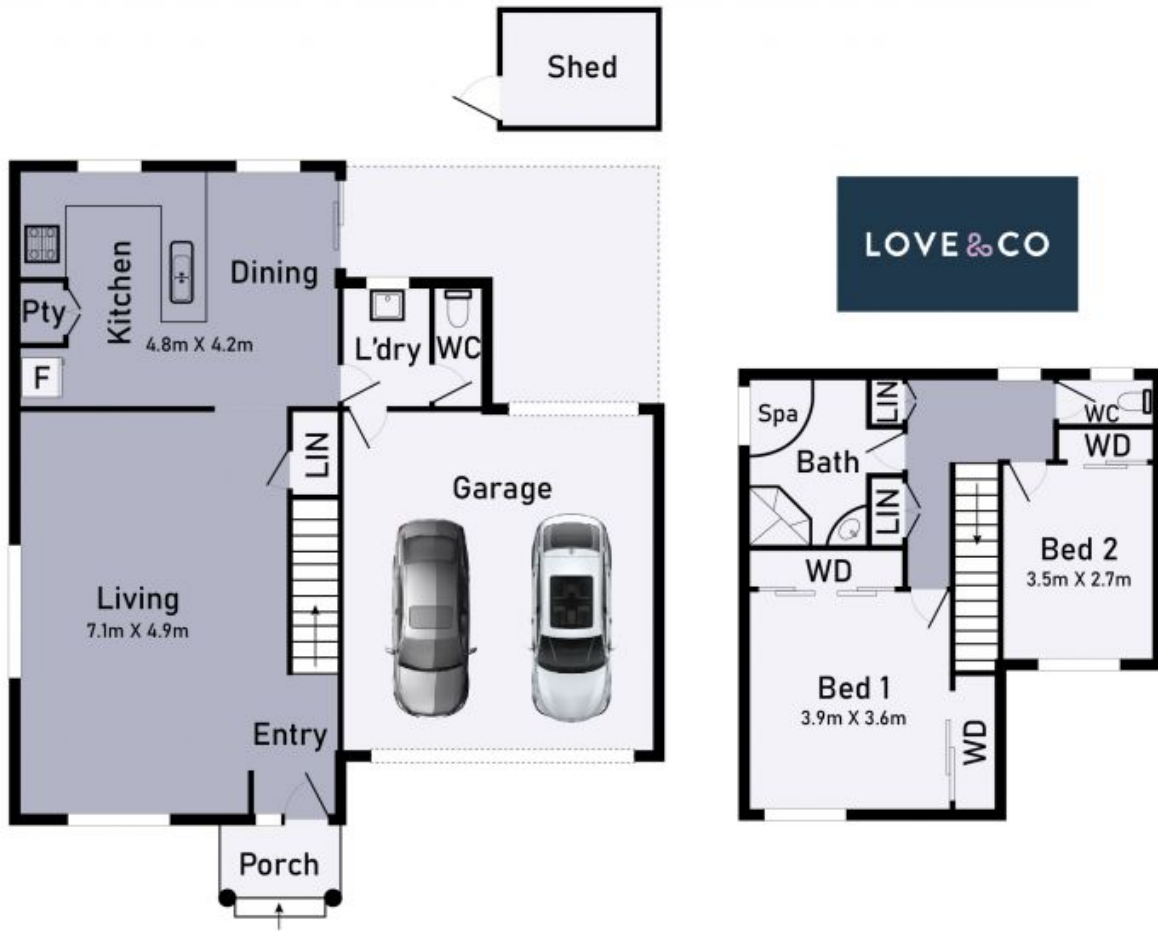

40 Wedge Street Epping

* Dimensions are approximate and for illustrative purposes only



LOVE & CO

40 Wedge Street

Epping, VIC