



11 Lipscomb Court Reservoir, VIC



4



3



2

Big, Bold & Beautiful

Situated in a serene cul-de-sac, this magnificent double-storey residence, now available for the first time in four decades, is a rare find. Ideal for families in search of generous living space, this home seamlessly blends comfort and convenience.

The ground floor boasts four distinct living zones, including a spacious dining area, a welcoming lounge, a rumpus room complete with a bar area, and a dedicated games room for the little ones. An added luxury is the presence of a ground floor bathroom, enhancing the functionality of this family haven. Upstairs, you'll discover four bedrooms, with the master bedroom featuring an ensuite, and all bedrooms providing the convenience of built-in robes. The well-appointed kitchen with an adjacent meals area is the heart of the home, perfect for gatherings and family meals. An additional living room offers a serene escape for relaxation, and an extra study or home office with delightful backyard views awaits your inspiration. The property also features a spacious double garage with internal access. You'll relish the opulent balconies that adorn both the front and rear of this residence, creating delightful spaces to soak in the surroundings. Located mere meters from the bustling Getz shopping strip, Darebin Creek Trail, Bundoora Park, and just a short drive to Keon Park station, this property combines tranquillity and accessibility for the ultimate

family lifestyle.

Due diligence checklist - for home and residential property buyers
<http://www.consumer.vic.gov.au/duediligencechecklist>



Jim Kalakias

0402 177 336
jim.k@lovere.com.au

LOVE & CO

Kannan Subramanian

0411 711 232
kannan.s@lovere.com.au

11 Lipscomb Court, Reservoir

LOVE & CO

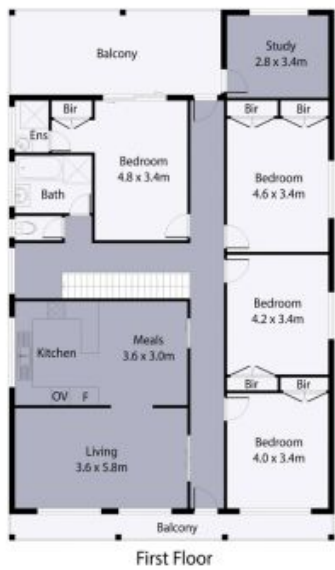

First Floor

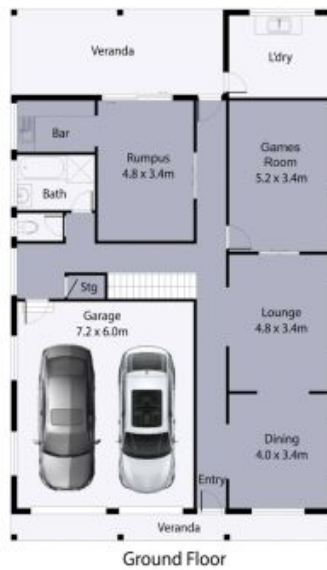

Ground Floor



Site Plan

THE ABOVE PLAN IS AN ARTIST'S IMPRESSION ONLY, IT INCLUDES ELEMENTS THAT ARE FOR DISPLAY PURPOSES ONLY AND MAY NOT BE TO SCALE. LANDSCAPING SHOWN IS INDICATIVE ONLY. DIMENSIONS ARE APPROXIMATE.



LOVE & CO

11 Lipscomb Court

Reservoir, VIC